



## DFCM Addendum #2

---

**Reference:** Logan Fish Hatchery Fencing  
DFCM Project #27309520  
U3P Event #CS26087

**Date:** June 25, 2026

**To:** General Contractors

**From:** The Division of Facilities Construction and Management

### Addendum Items

---

**Solicitation Schedule Changes:** There are no changes to the Solicitation Schedule in this addendum.

- DFCM Addendum Items:**
- Questions and Answers
  - Project Narrative Correction
  - Additive Alternate Gate Cut Sheet
  - UDOT Utility Plans

**A/E Addendum Items:** A/E Addendum # N/A

---

**Total Attached Pages:** 9

*Note:*  
This

Addendum shall be included as part of the Contract Documents. Items in this Addendum apply to all drawings and specification sections whether referenced or not involving the portion of the work added, deleted, modified, or otherwise addressed in the Addendum. Bidders are required to acknowledge receipt of this Addendum when their bid is submitted. Failure to do so may subject the Bidder to disqualification.

## DFCM Addendum #2

### DNR – Logan Fish Hatchery Fencing

#### Contents

- Questions and Answers
- Project Narrative Correction
- Additive Alternate Gate Cut Sheet
- UDOT Utility Plans

DNR – Logan Fish Hatchery Fencing

Project 27309520

Questions and Addendum

**Q: Is there currently an estimated mobilization date?**

*A: Mobilization will occur on approximately August 3, 2026.*

**Q: The description page in the plan set calls for chain link fence demo, but none is shown or called out on the plans.**

*A: The existing chain link fence running from the east entrance to the settling basin belongs to UDOT and will be removed by UDOT.*

**Q: The description page in the plan set calls for 8' chain link gates, but there aren't any details in the plans. Please provide.**

*A: The description calls for a 16 foot wide chain link gate across the west entrance. This gate should be (2) 8ft x 6ft panels with 2 inch 9 gauge woven mesh chain link.*

**Q: The description page in the plans calls for wood fence to be demolished, but there is nothing shown or called out on the plans. Please clarify.**

*A: The wood fence extends from the east entrance to the eastern property boundary for 99 feet and shall be demolished by the contractor. The wood fence on the east property boundary shall remain intact.*

**Q: Will rebar cages be required for the concrete post footings? There is only 1 J bar shown on the detail.**

*A: Footing and fence panel should be installed with the column as per the drawing with the (2) #5 rebar dowel with std. hook to post.*

**Q: Please clearly identify on the drawings the location where the fence will be installed, what areas are to be at a lower height to allow for employees leaving the parking area to see oncoming traffic.**

*A: The concrete panel fence footing should be installed 1 foot north of the UDOT staked right-of-way. The east entrance shall have one 4 foot high 12 long concrete panel fence on both of the east and west sides of the entrance extending to the north at a 45 degree angle.*

**Q: During the job walk it was discussed that stump removal might be required. Please qualify if the stumps are to be removed or ground below grade and the quantity of stumps to be addressed.**

*A: There are 2 stumps next to each other which should be removed so that they do not interfere with the footing placement.*

**Q: During the job walk metal gates were discussed at the parking lot entrance and access to the middle of the hatchery. What specific type of gates, size of gates, and operators or opening systems are required for these gates?**

*A: The request is for an additive alternate bid for double in-ground manual swing barrier gate with 2x10 arms (galvanized) installed at the east entrance. See the attached cut sheet.*

**Q: Please identify the length of chain link fence that is required to be included in the base bid that will be installed after the concrete fencing. It was discussed that the concrete fence will end wherever the last full concrete panel ends just past the West concrete retention pond.**

*A: The chain link fence shall extend from the last concrete panel on the west past the settling basin 310 feet and intersect with the chain link fence running from northeast to southwest.*

# Logan Fish Hatchery Fence Demolition & Construction Narrative

## 1. General Provisions & Contractor Responsibility

- **Field Verification:** The contractor shall be solely responsible for verifying all property lines, right-of-way stakes, and physical measurements in the field prior to ordering materials or commencing construction. All footages provided in this narrative are approximations for bidding purposes.
- **Property Line Alignment:** The fence must be constructed just north of the UDOT right-of-way stakes, ensuring the entire footprint rests securely on UDWR property.

## 2. Coordination and Phasing (Security & Chain-Link Removal)

- **Temporary Chain-Link Fence:** The existing chain-link fence and t-posts belong to the UDOT contractor widening US Highway 30. **Do not demolish or dispose of this fencing.**
- **Removal Timing:** The Utah Division of Wildlife Resources (UDWR) will facilitate coordination with UDOT to have their contractor collect the temporary fence.
- **Scheduling:** This removal must be scheduled to occur as close to the new fence installation date as possible to minimize security risks to the property.

## 3. Demolition and Disposal

- **South Wood Fencing:** Demolish and dispose of the wood fence located south of the caretaker's residence.
- **East Wood Fencing:** The existing wood fence on the east side of the caretaker's residence **shall remain intact** and undisturbed.

## 4. Fence Construction

### Concrete Fencing (8-Foot Height)

- **Height Requirement:** The main run of the precast concrete fence shall stand **8 feet tall**.
- **Alignment:** Construct the new concrete fence entirely just north of the marked UDOT right-of-way stakes.
- **East Terminus (Future Expansion Corner):**
  - Tie ~~the concrete fence into the existing wood fence at the current caretaker's residence on the east end~~ of the property. **The concrete fence does not need to tie into eastern corner of the wood fence, but must extend one panel towards the wood fence's south eastern corner.**
  - From the **East Entrance**, run the concrete fence eastward **approximately 112 feet** to the eastern terminus.
  - Form a 90-degree corner at this eastern terminus and extend exactly **one concrete panel northward**.
  - Position this northern-facing panel as close to the neighbor's existing barbed wire fence as possible to accommodate future northern fence expansion.
- **Main Run (East to West Entrance):** From the East Entrance, run the concrete fence westward **approximately 360 feet** to the West Entrance.

- **Old Caretaker's Residence (Small House Driveway):** Run the concrete fence continuously across the entrance of the old caretaker's residence. This driveway/entrance **shall be completely blocked** by the fence and will not be left open.
- **West Run (West Entrance to West Terminus):** From the West Entrance, run the concrete fence westward **approximately 175 feet** to the western terminus. The concrete fence shall extend exactly one panel beyond the settling basin.

**Western Chain-Link Extension (6-Foot Height)** The chain link should be a standard 2 inch 9 guage woven mesh.

- **Transition:** At the western terminus of the concrete fence, transition to standard chain-link fencing.
- **Height Requirement:** The chain-link portion of the fence shall stand **6 feet tall**.
- **Extension:** Run the new 6-foot chain-link fence westward **approximately 310 feet**, following just north of the property/right-of-way line, where it will tie directly into the existing UDWR chain-link fence at the end of the property boundary. **The new chain link fence will have to span a ditch close to the intercept point.**

## 5. Entrances and Gates

### West Entrance

- Leave a designated opening for the west entrance.
- ~~Extend a half height concrete panel into the property on both the east and west sides of this entrance.~~  
There shall be no northern extension of concrete fence panels on the east and west of the west entrance.
- Supply and install a **16-foot wide chain-link gate** across this opening.

### East Entrance

- Leave a designated opening for the east entrance.
- **Angled Layout:** Construct a short concrete panel angled inward at **45 degrees** on both the east and west sides of this entrance.
- **Future Gate Provision:** Ensure the post/panel design allows for the seamless installation of a gate in the future.
- **Additive Alternate:** Provide a separate cost estimate/bid item for the procurement and installation of an **8-foot bar gate** at this entrance. **The requested add alternate is for an additive alternate bid for double in-ground manual swing barrier gate with 2x10 arms (galvanized) installed at the east entrance.**

The right-of-way east of the east entrance jogs at an angle to the south. The concrete fence must follow this angle while avoiding all of the underground utilities.



## Sentinel Double In-Ground Manual Swing Barrier Gate with 2x 10ft Arms (20ft/6.09m) (Galvanized)



### Details

#### Sentinel Double In-Ground Manual Swing Barrier Gate with 2x 10ft Arms (20ft/6.09m) (Galvanized)

These Galvanized Swing Sentinel 20' Manual Double Leaf Swing Barrier Gate Arms now use Shut It Dual Sealed Bearing Hinges for optimal performance. These easy-to-install barrier gate arms features a lock assembly to accept a padlock, two 10' leaf lengths, and a weather-resistant galvanized finish. A [Sentinel Swing Barrier Receiver Post](#) is optional and sold separately. The Galvanized Swing Sentinel 20' Manual Double Leaf Swing Barrier Gate Arms include an eye lock with a 1 3/8" inside diameter that allows you to securely attach the barrier arms to the receiver post using an external lock (sold separately).

#### Features:

- Manual Swing Gate Barrier Arms
- Enhanced Design, Easy To Install
- Lock Assembly To Accept A Padlock
- Uses Shut It Dual Sealed Bearing Hinges
- Includes 7' Tall Commercial Gate Post

[Sentinel Swing Barrier Receiver Post](#) Optional (Sold Separately)

#### Specifications:

- Length: 20'

- Finish: Galvanized
- Gate Type: Manual
- Gate Post Size: 3" [2 7/8"OD] x 7'
- Eye Lock Internal Diameter: 1 3/8"

Our sentinel steel gates are 100% made in the USA, fully compliant with the Buy American Act (BAA), Build America, Buy America Act (BABAA), American Iron and Steel (AIS) provisions, and Federal Transit Administration/Federal Highway Administration Buy America requirements. All manufacturing processes, from melting to coating, occur in the United States, ensuring eligibility for federal and state-funded projects without the need for waivers.

SKU	14020-20
Part Number	14020.220
Finish	Galvanized
Length	20'
Gate Leaf Type	Double Gate
Height	7'
Gate Post Size	3" [2 7/8" OD] x 7'
Manufacturer	Barrier Gate Brands™
Buy American Act Certification	<a href="#">Download PDF file</a>

**You may also be interested in the following product(s)**



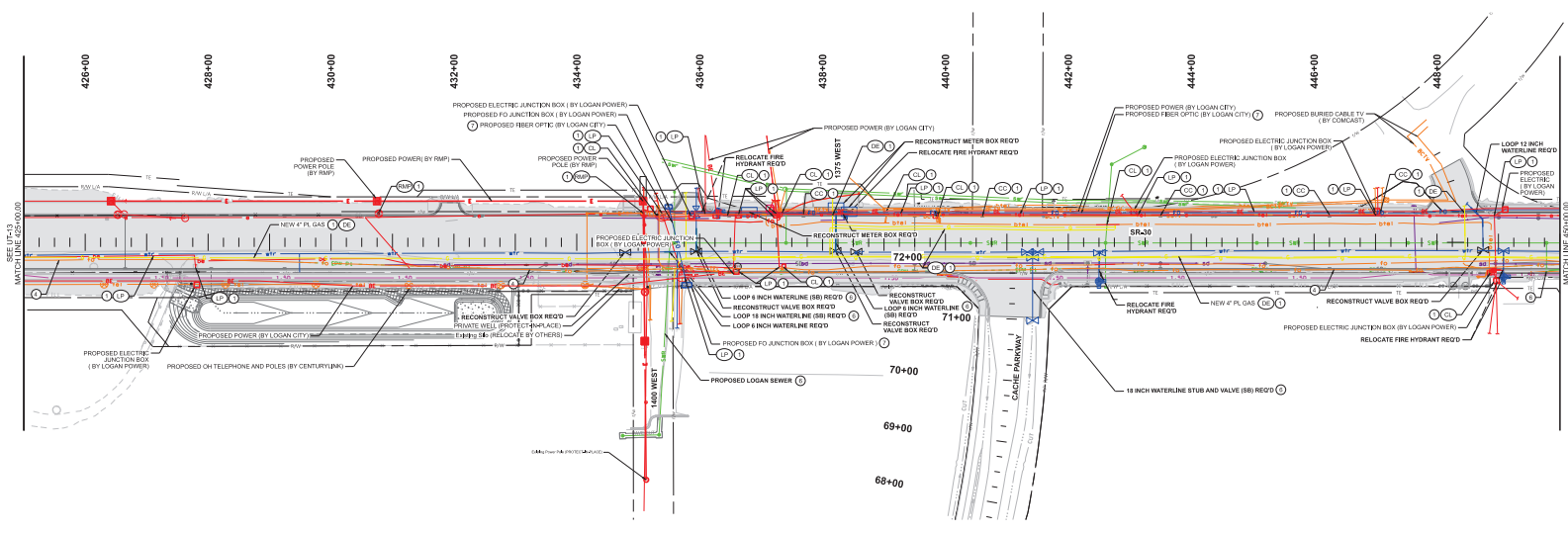

**LEGEND:**  
 EXTENT OF ROAD WORK

QUALITY LEVEL	DEFINITION
A	ONLY AT LOCATION WHERE THE UTILITY IS EXPOSED AND DERIVED FOR VERTICAL DEPTH
B	LOCATION NOT REVEALED THROUGH EXISTING SURFACE UTILITIES
C	LOCATION BASED ON PERFORMANCE OF ABOVE-GROUND UTILITIES
D	LOCATION BASED ON SURVEY RECORDS AND/OR RECONSTRUCTION

ALL UTILITIES ARE QUALITY LEVEL D UNLESS NOTED OTHERWISE ON THE PLANS OR AT TEST HOLE LOCATIONS.

UTILITY COMPANY SYMBOLS LEGEND	
	ROCKY MOUNTAIN POWER
	CENTURYLINK LOCAL AREA NETWORK
	DOMINION ENERGY UTAH
	COMCAST
	LOGAN LIGHT AND POWER

EQUIPMENT LEGEND	
	EXISTING LUMINARE POLE
	40' HIGHWAY LUMINARE POLE WITH SINGLE ARM
	17.5' STANDARD POLE WITH 27' SCHEDULE 40 POLE CAP
	LIGHTING PACK INSTALLED IN BOX OR OVERLIFT
	EXISTING JUNCTION BOX
	PROPOSED TYPE A JUNCTION BOX
	ELECTRICAL TRANSFORMER
	POWER POLE
	WATER VALVE
	FIRE HYDRANT
	WATER METER
	INFILTRATION BOX
	TELEPHONE BOX
	MANHOLE
	WATER MANHOLE
	TELEPHONE MANHOLE
	STORM DRAIN MANHOLE
	SANITARY SEWER MANHOLE
	PROPOSED CATCH BASIN
	LIGHT POLE IDENTIFICATION
	4" x 4" EXISTING POLE
	6" x 6" EXISTING POLE
	8" x 8" EXISTING POLE
	12" x 12" EXISTING POLE
	PROPOSED POWER POLE
	TEST HOLE LOCATION
	PUBLIC UTILITY EASEMENT

**UTAH DEPARTMENT OF TRANSPORTATION**  
**AVENUE CONSULTANTS**

PROJECT: SR-30; SR-23 TO SR-252  
 PROJECT NUMBER: F-0030(09)102  
 SHEET NO.: UT-148

APPROVED: [Signature] DATE: 07/17/2024  
 DRAWN BY: SVL  
 QC CHECKED BY: JAW  
 DATE APPROVED BY: [Signature]

FOR INFORMATION ONLY  
 PROFESSIONAL ENGINEER

NO.	DATE	APPROVED BY	REMARKS