

---

**CONTRACT ADDENDUM #**

**date:** 5.10.24  
**project:** Nibley Middle School  
**by:** Michael Rigby  
**subject:** Addendum 02

---

The Work shall be carried out in accordance with the following supplemental instructions issued in accordance with the Contract Documents. Prior to proceeding in accordance with these instructions, indicate your acceptance of these instructions for minor change to the work as consistent with the Contract Documents and return a copy to the Architect.

**Items:**

Clarification and changes from Bid Package 1 to Bid Package 2. Includes update to the concrete openings, structural items – see structural narrative, and civil items – see civil narrative.

- 02.01      A-111.0 – PLAN – LEVEL 01 – AREA A – SLAB & FOUNDATION
  - ROUGH OPENING (RO) OF CONCRETE/ICF OPENING.
- 02.02      A-112.0 – PLAN – LEVEL 01 – AREA B – SLAB & FOUNDATION
  - ROUGH OPENING (RO) OF CONCRETE/ICF OPENING.
- 02.03      A-113.0 – PLAN – LEVEL 01 – AREA C – SLAB & FOUNDATION
  - ROUGH OPENING (RO) OF CONCRETE/ICF OPENING.
- 02.04      A-114.0 – PLAN – LEVEL 01 – AREA D – SLAB & FOUNDATION
  - ROUGH OPENING (RO) OF CONCRETE/ICF OPENING.
- 02.05      A-115.0 – PLAN – LEVEL 01 – AREA E – SLAB & FOUNDATION
  - ROUGH OPENING (RO) OF CONCRETE/ICF OPENING.
- 02.06      A-115.0 – PLAN – LEVEL 01 – AREA F – SLAB & FOUNDATION
  - ROUGH OPENING (RO) OF CONCRETE/ICF OPENING.
- 02.07      See attached Civil Items
- 02.08      See attached Structural Items

**Sheets:**

Updated Structural and Civil Sheets

- A-111.0 – PLAN – LEVEL 01 – AREA A – SLAB & FOUNDATION
- A-112.0 – PLAN – LEVEL 01 – AREA B – SLAB & FOUNDATION
- A-113.0 – PLAN – LEVEL 01 – AREA C – SLAB & FOUNDATION
- A-114.0 – PLAN – LEVEL 01 – AREA D – SLAB & FOUNDATION
- A-115.0 – PLAN – LEVEL 01 – AREA E – SLAB & FOUNDATION
- A-115.0 – PLAN – LEVEL 01 – AREA F – SLAB & FOUNDATION

Michael Rigby                      5.10.24

---

ISSUED BY                              Date  
Architect

ACCEPTED BY                              Date  
Contractor

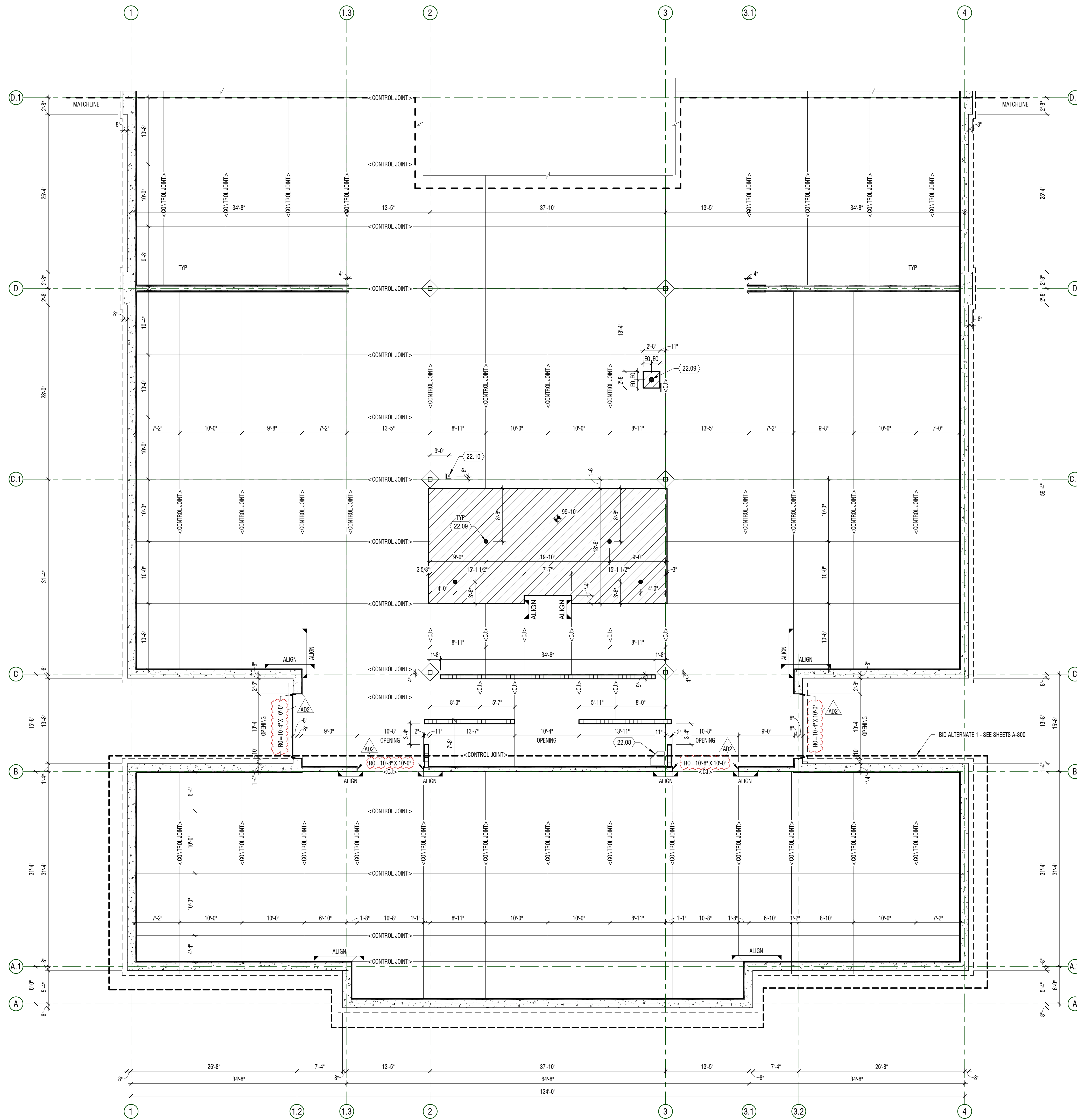

**GENERAL NOTES**

- CONTRACTOR SHALL BE FAMILIARIZED WITH THE LAY-OUT OF STRUCTURAL, MECHANICAL, AND ELECTRICAL DRAWINGS. ANY QUESTIONS SHALL BE SUBMITTED VIA REQUEST FOR INFORMATION (RFI).
- DIMENSIONS ARE FROM GRID TO CENTERLINE OF COLUMN, DRAINS, ETC., U.N.O. AND EDGE OF ICF FOAM BLOCKS.
- COORDINATE WITH STRUCTURAL DRAWINGS FOR SIZE AND DEPTH OF FOOTING, METAL DECK, AND OTHER DETAILS.
- NOT ALL SLAB PENETRATIONS ARE SHOWN ON PLAN. COORDINATE WITH PLUMBING AND MECHANICAL DRAWINGS FOR ADDITIONAL DEVIATIONS.
- SLOPE ALL SETTING BEDS TO FLOOR DRAINS U.N.O.
- REVEAL TO OCCUR AT EXTERIOR GRADE. SEE BID PACKAGE 2 FOR PROFILE.
- ROUGH OPENINGS (RO) INDICATED AT RO OPENINGS WIDTH X HEIGHT. SEE A11-A-578 FOR HOLLOW METAL DOOR FRAMING STANDARDS. FIELD VERIFY ALL STOREFRONT OPENINGS.

**KEYNOTES**

| MARK  | DESCRIPTION  |
|-------|--|
| 22.08 | WOP SINK   |
| 22.09 | FLOOR DRAIN - SLOPE FLOOR TO DRAIN                                       |
| 22.10 | FLOOR SINK FOR EQUIPMENT - COORDINATE WITH PLUMBING AND KITCHEN DRAWINGS |

**LEGEND**

- CONCRETE SLAB
- TUBULAR CONCRETE FORM BLOCK-OUTS
- RECESSED SLAB - SEE PLAN FOR ELEVATION
- ELEVATOR PIT
- 2'-0" x 2'-0" x 2'-0" SUMP AT ELEVATOR PIT

**KEY PLAN**

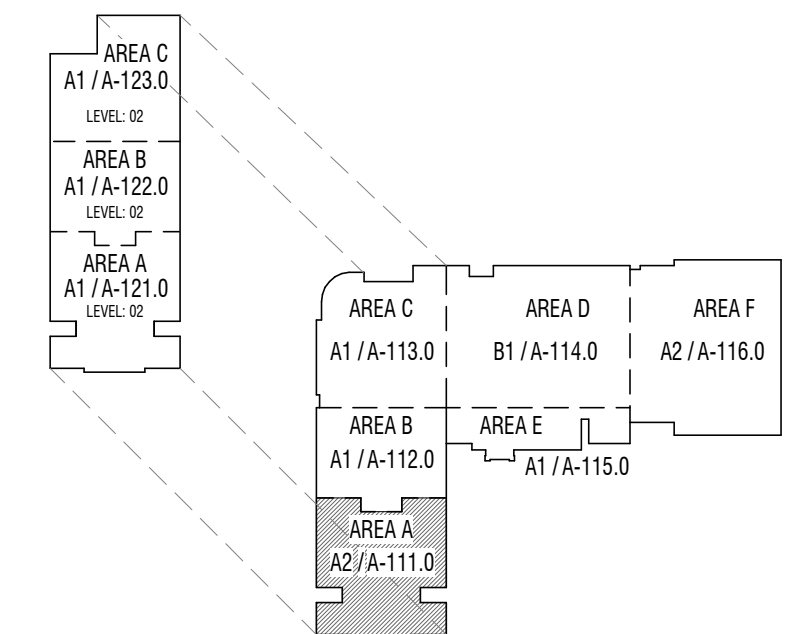

**A2 PLAN - SLAB**  
1/8" = 1'-0" AREA A - LEVEL 01



**CONSTRUCTION DOCUMENTS**

| MARK | DATE        | DESCRIPTION                               |
|------|-------------|---|
| A102 | MAY 07 2024 | ADDITIONAL 02 - BID PACKAGE 2 FOR RELEASE |

PROJECT #: 123006  
DRAWN BY: LOYND  
CHECKED BY: RIGBY  
ISSUED: 05.02.2024

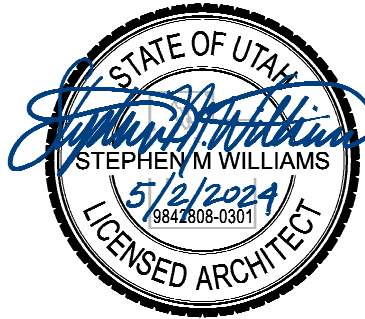

PLAN - LEVEL 01 - AREA A - SLAB & FOUNDATION

E  
D  
C  
B  
A

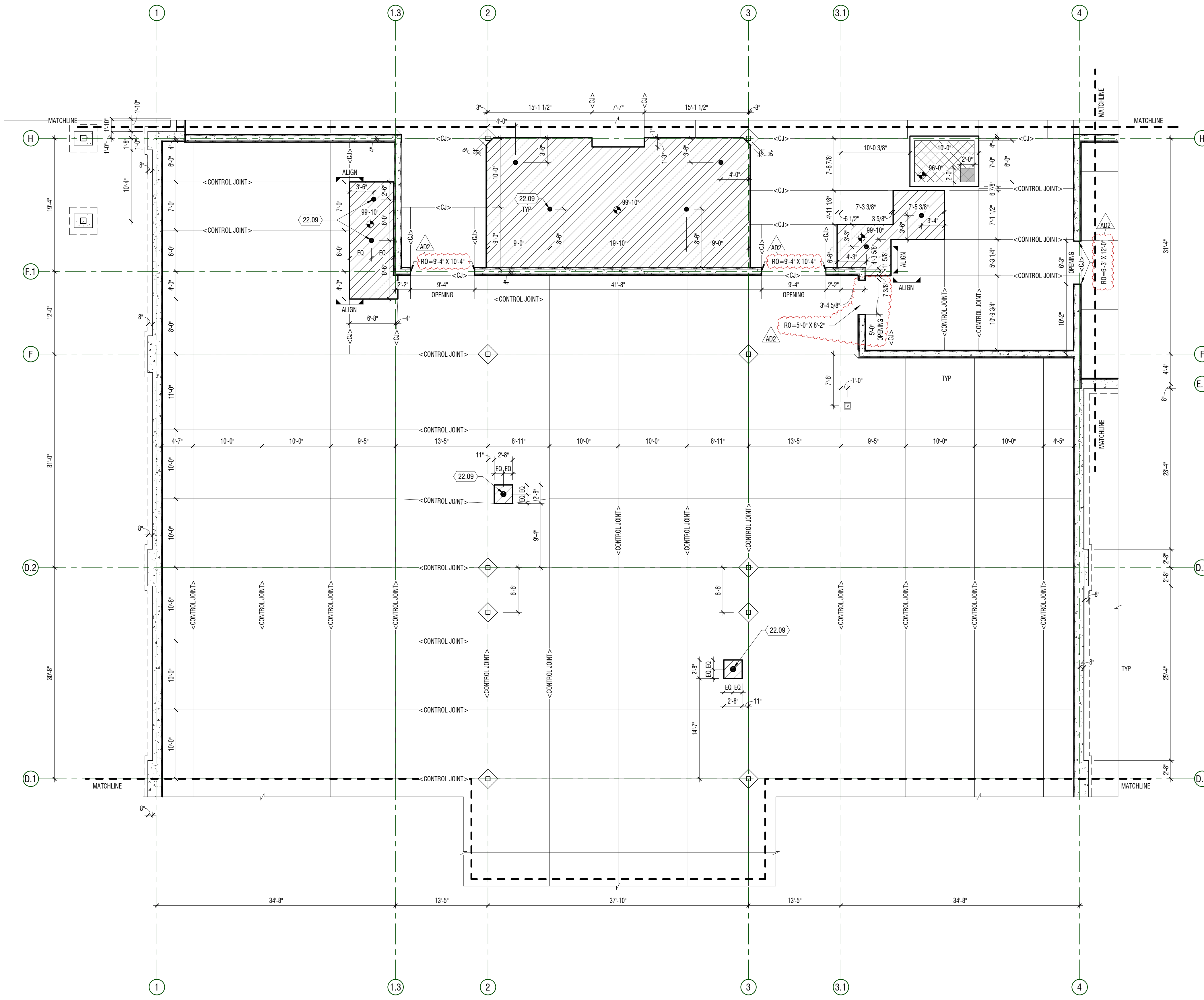

**A1** PLAN - SLAB  
1/8" = 1'-0" AREA B - LEVEL 01



**GENERAL NOTES**

- CONTRACTOR SHALL BE FAMILIARIZED WITH THE LAY-OUT OF STRUCTURAL, MECHANICAL, AND ELECTRICAL DRAWINGS. ANY QUESTIONS SHALL BE SUBMITTED VIA REQUEST FOR INFORMATION (RFI).
- DIMENSIONS ARE FROM GRID TO CENTERLINE OF COLUMN, DRAINS, ETC., U.N.O. AND EDGE OF ICF FOAM BLOCKS.
- COORDINATE WITH STRUCTURAL DRAWINGS FOR SIZE AND DEPTH OF FOOTING, METAL DECK, AND OTHER DETAILS.
- NOT ALL SLAB PENETRATIONS ARE SHOWN ON PLAN. COORDINATE WITH PLUMBING AND MECHANICAL DRAWINGS FOR ADDITIONAL DEVIATIONS.
- SLOPE ALL SETTING BEDS TO FLOOR DRAINS U.N.O.
- REVEAL TO OCCUR AT EXTERIOR GRADE. SEE BD PACKAGE 2 FOR PROFILE.
- ROUGH OPENINGS (RO) INDICATED AT ICF OPENINGS WITH X HEIGHT. SEE A1/A-578 FOR HOLLOW METAL DOOR FRAMING STANDARDS. FIELD VERIFY ALL STOREFRONT OPENINGS.

**KEYNOTES**

| MARK  | DESCRIPTION                        |
|-------|------------------------------------|
| 22.09 | FLOOR GRAIN - SLOPE FLOOR TO DRAIN |

**LEGEND**

- CONCRETE SLAB
- TUBULAR CONCRETE FORM BLOCK-OUTS
- RECESSED SLAB - SEE PLAN FOR ELEVATION
- ELEVATOR PIT
- 2'-0" x 2'-0" x 2'-0" SUMP AT ELEVATOR PIT

**KEY PLAN**

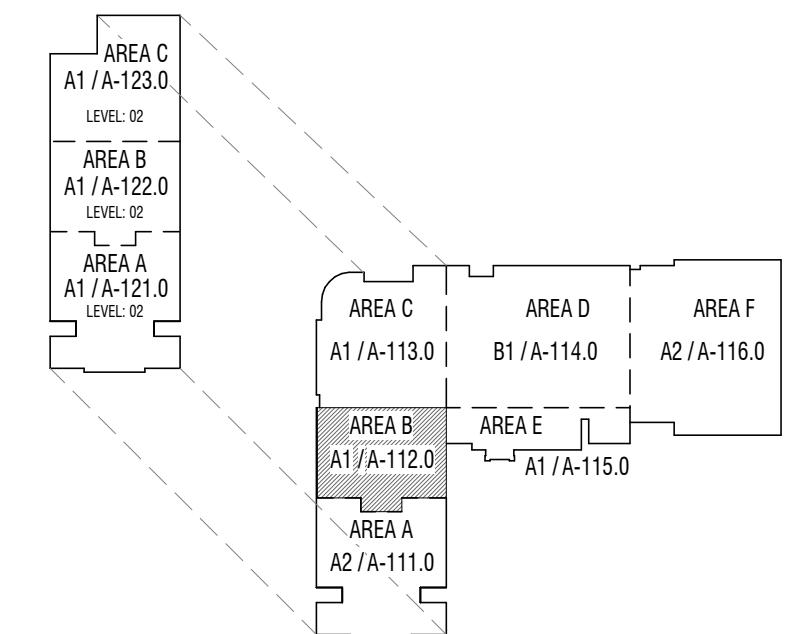

**CONSTRUCTION DOCUMENTS**

| MARK | DATE        | DESCRIPTION                                |
|------|-------------|--|
| A12  | MAY 07 2024 | ADDITIONAL ICF - BID PACKAGE 2 FOR RELEASE |

PROJECT #: 123006  
DRAWN BY: LOYND  
CHECKED BY: RIGBY  
ISSUED: 05.02.2024

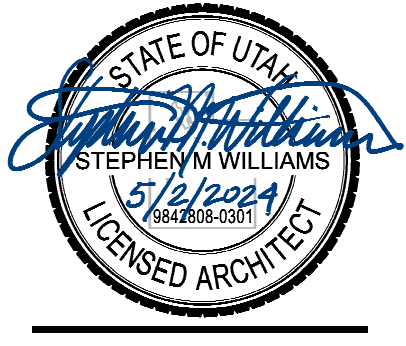

PLAN - LEVEL 01 - AREA B - SLAB & FOUNDATION

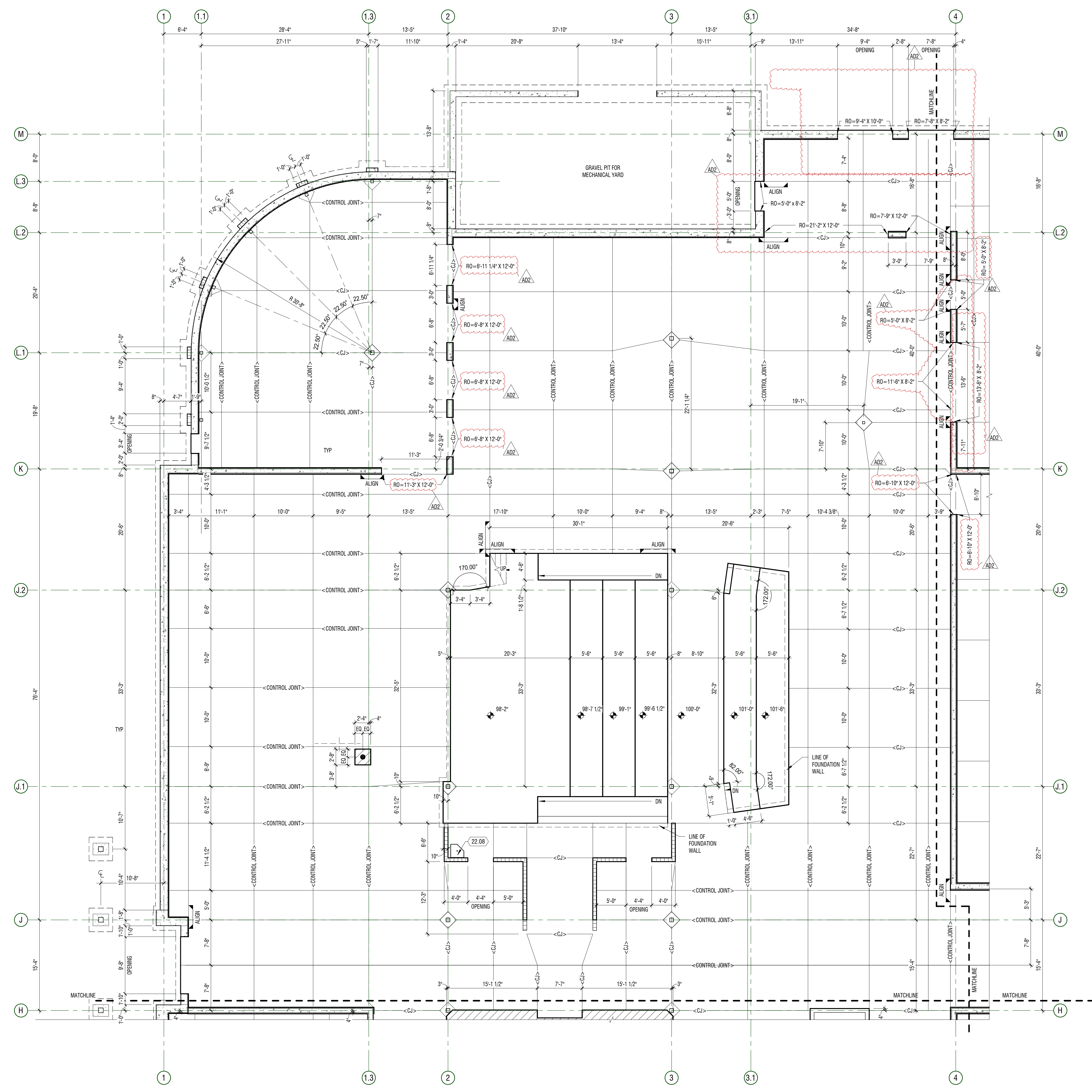

- ### GENERAL NOTES
- CONTRACTOR SHALL BE FAMILIARIZED WITH THE LAY-OUT OF STRUCTURAL, MECHANICAL, AND ELECTRICAL DRAWINGS. ANY QUESTIONS SHALL BE SUBMITTED VIA REQUEST FOR INFORMATION (RFI).
  - DIMENSIONS ARE FROM GRID TO CENTERLINE OF COLUMN, DRAINS, ETC., U.I.O. AND EDGE OF ICF FOAM BLOCKS.
  - COORDINATE WITH STRUCTURAL DRAWINGS FOR SIZE AND DEPTH OF FOOTING, METAL DECK, AND OTHER DETAILS.
  - NOT ALL SLAB PENETRATIONS ARE SHOWN ON PLAN. COORDINATE WITH PLUMBING AND MECHANICAL DRAWINGS FOR ADDITIONAL DEVIATIONS.
  - SLOPE ALL SETTING BEDS TO FLOOR DRAINS U.I.O.
  - REVEAL TO OCCUR AT EXTERIOR GRADE. SEE RD PACKAGE 2 FOR PROFILE.
  - ROUGH OPENINGS (RO) INDICATED AT OPENINGS WIDTH X HEIGHT. SEE A11-A-578 FOR HOLLOW METAL DOOR FRAMING STANDARDS. FIELD VERIFY ALL STOREFRONT OPENINGS.

### KEYNOTES

| MARK  | DESCRIPTION |
|-------|-------------|
| 22.08 | MOP SINK    |

### LEGEND

|          |  |
|----------|--|
| [Symbol] | CONCRETE SLAB                              |
| [Symbol] | TUBULAR CONCRETE FORM BLOCK-OUTS           |
| [Symbol] | RECESSED SLAB - SEE PLAN FOR ELEVATION     |
| [Symbol] | ELEVATOR PIT                               |
| [Symbol] | 2'-0" x 2'-0" x 2'-0" SUMP AT ELEVATOR PIT |

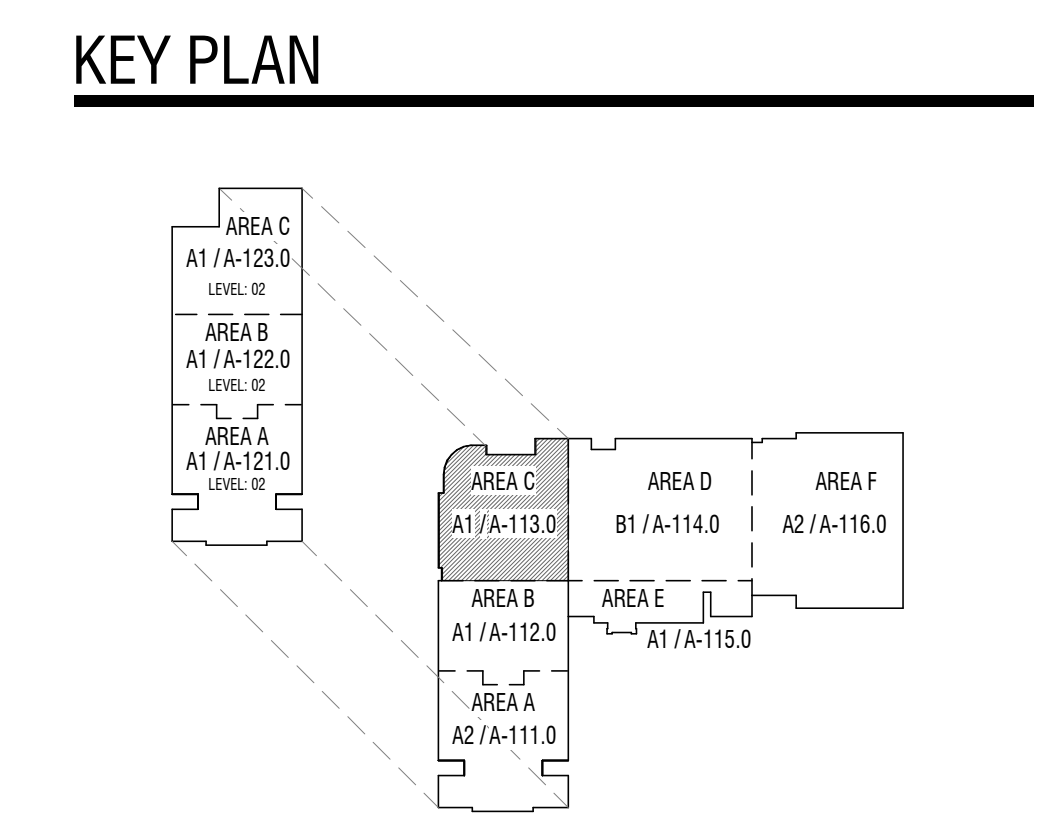

**A1** PLAN - SLAB  
1/8" = 1'-0"  
AREA C - LEVEL 01

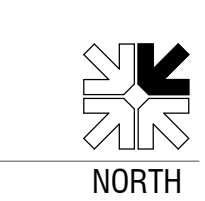

| MARK | DATE        | DESCRIPTION                               |
|------|-------------|---|
| A102 | MAY 07 2024 | ADDITIONAL ICF - RD PACKAGE 2 FOR RELEASE |

|             |            |
|-------------|------------|
| PROJECT #:  | 123006     |
| DRAWN BY:   | LOYND      |
| CHECKED BY: | RIGBY      |
| ISSUED:     | 05.02.2024 |

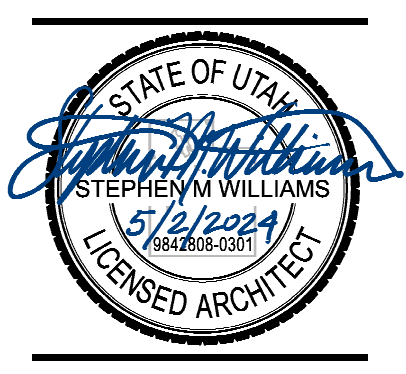

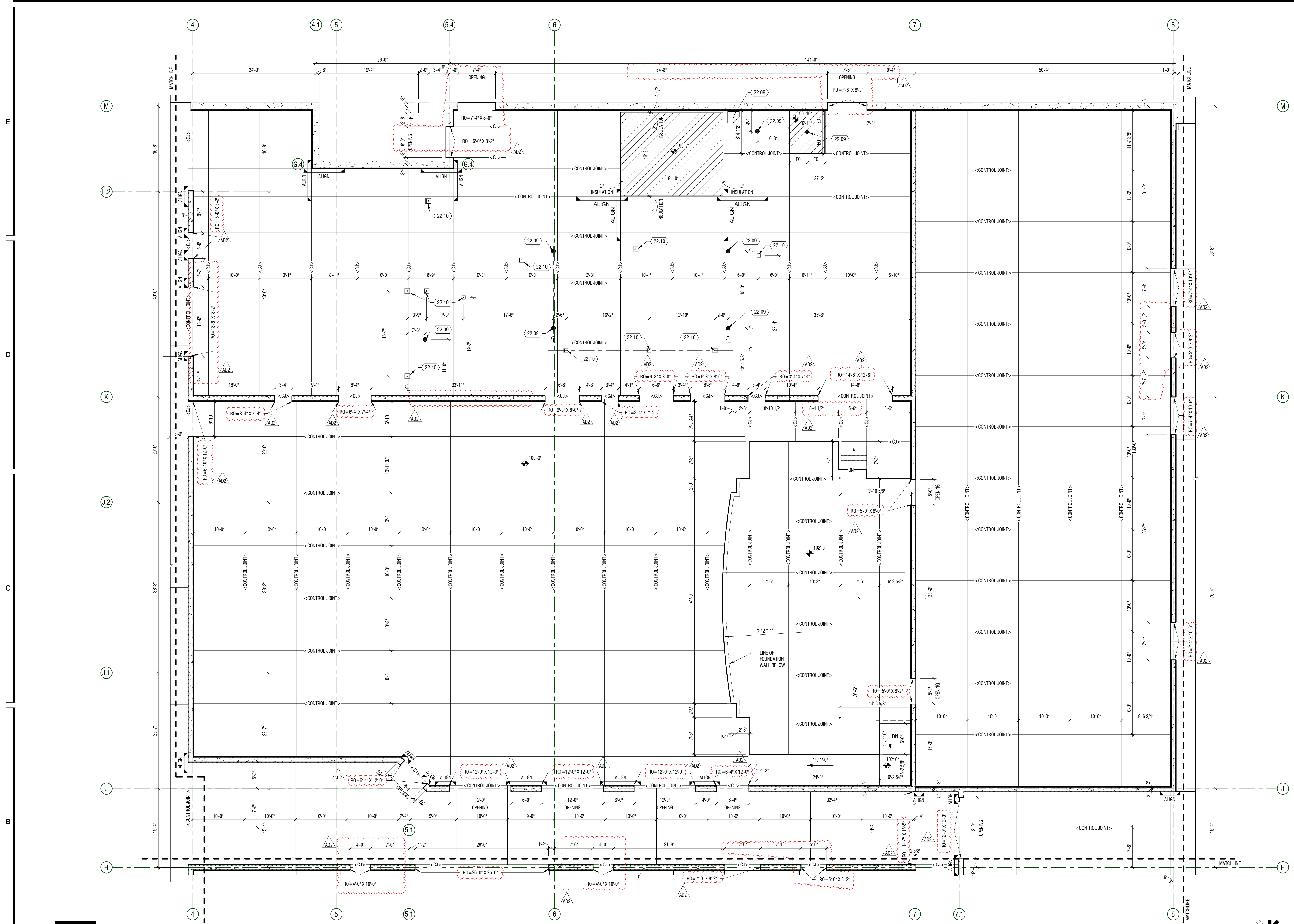

- ### GENERAL NOTES
- CONTRACTOR SHALL BE FAMILIARIZED WITH THE LAY-OUT OF STRUCTURAL, MECHANICAL, AND ELECTRICAL DRAWINGS. ANY QUESTIONS SHALL BE SUBMITTED VIA REQUEST FOR INFORMATION (RFI).
  - DIMENSIONS ARE FROM GRID TO CENTERLINE OF COLUMN, DRAINS, ETC. U.A.O. AND EDGE OF ICF FOAM BLOCKS.
  - COORDINATE WITH STRUCTURAL DRAWINGS FOR SIZE AND DEPTH OF FOOTING, METAL DECK, AND OTHER DETAILS.
  - NOT ALL SLAB PENETRATIONS ARE SHOWN ON PLAN. COORDINATE WITH PLUMBING AND MECHANICAL DRAWINGS FOR ADDITIONAL DEVIATIONS.
  - SLOPE ALL SETTING BEDS TO FLOOR DRAINS U.N.O.
  - REVEAL TO OCCUR AT EXTERIOR GRADE. SEE BID PACKAGE 2 FOR PROFILE.
  - ROUGH OPENING (RO) INDICATED AT TOP OF OPENINGS WITH X HEIGHT. SEE A11-A-578 FOR HOLLOW METAL DOOR FRAMING STANDARDS. FIELD VERIFY ALL STOREFRONT OPENINGS.

### KEYNOTES

| MARK  | DESCRIPTION  |
|-------|--|
| 22.08 | MOP SINK   |
| 22.09 | FLOOR DRAIN - SLOPE FLOOR TO DRAIN                                       |
| 22.10 | FLOOR SINK FOR EQUIPMENT - COORDINATE WITH PLUMBING AND KITCHEN DRAWINGS |

### LEGEND

|  |  |
|--|--|
|  | CONCRETE SLAB                          |
|  | TUBULAR CONCRETE FORM BLOCK-OUTS       |
|  | RECESSED SLAB - SEE PLAN FOR ELEVATION |
|  | ELEVATOR PIT                           |
|  | 2'-0\"/>                               |

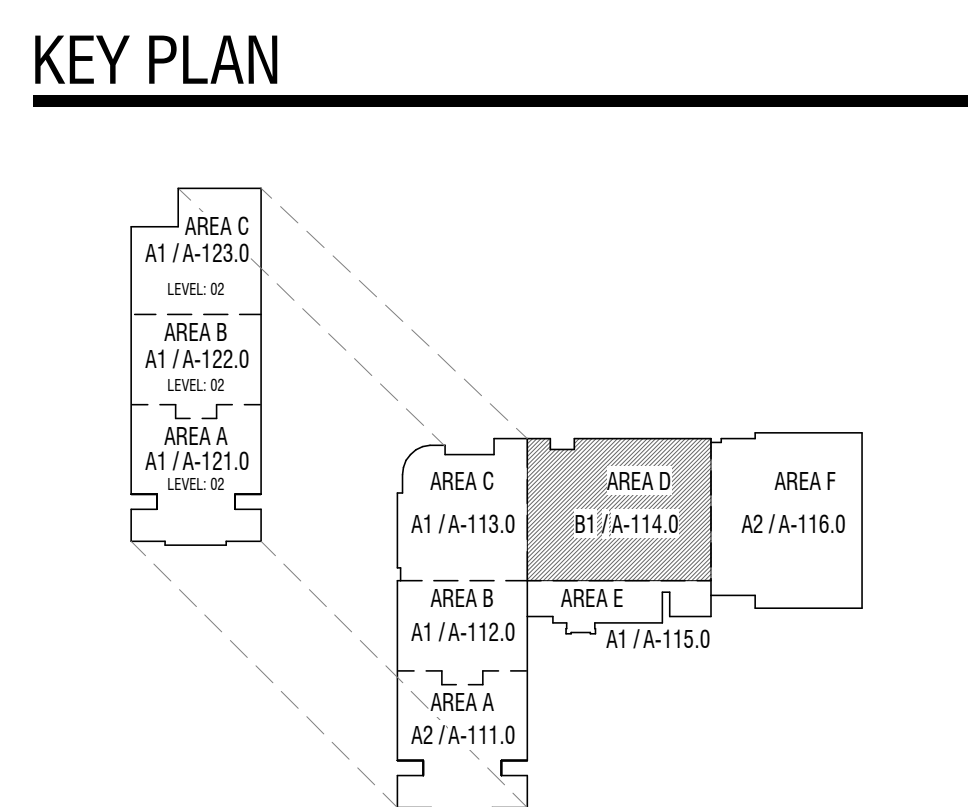

**B1 PLAN - SLAB**  
1/8" = 1'-0"  
AREA D - LEVEL 01

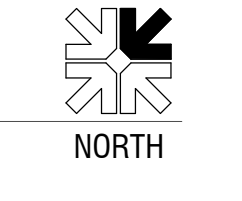

| MARK | DATE         | DESCRIPTION                                |
|------|--------------|--|
| A102 | MAY 10, 2024 | APPROXIMATE 02 - BID PACKAGE 2 PER RELEASE |

PROJECT #: 123006  
DRAWN BY: LYND  
CHECKED BY: RIGBY  
ISSUED: 05.02.2024

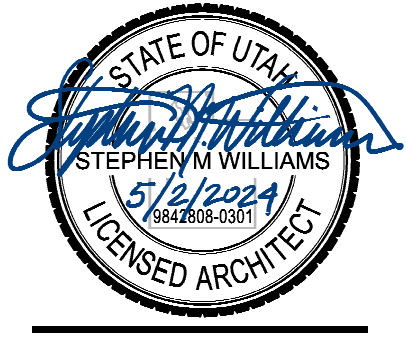

PLAN - LEVEL 01 -  
AREA D - SLAB &  
FOUNDATION



**GENERAL NOTES**

- CONTRACTOR SHALL BE FAMILIARIZED WITH THE LAY-OUT OF STRUCTURAL, MECHANICAL, AND ELECTRICAL DRAWINGS. ANY QUESTIONS SHALL BE SUBMITTED VIA REQUEST FOR INFORMATION (RFI).
- DIMENSIONS ARE FROM GRID TO CENTERLINE OF COLUMN, DRAINS, ETC., U.N.O. AND EDGE OF ICF FOAM BLOCKS.
- COORDINATE WITH STRUCTURAL DRAWINGS FOR SIZE AND DEPTH OF FOOTING, METAL DECK, AND OTHER DETAILS.
- NOT ALL SLAB PENETRATIONS ARE SHOWN ON PLAN. COORDINATE WITH PLUMBING AND MECHANICAL DRAWINGS FOR ADDITIONAL DEVIATIONS.
- SLOPE ALL SETTING BEDS TO FLOOR DRAINS U.N.O.
- REVEAL TO OCCUR AT EXTERIOR GRADE. SEE BID PACKAGE 2 FOR PROFILE.
- ROUGH OPENINGS (RO) INDICATED AT ICF OPENINGS WITH X HEIGHT. SEE A1/A-578 FOR HOLLOW METAL DOOR FRAMING STANDARDS. FIELD VERIFY ALL STOREFRONT OPENINGS.

**KEYNOTES**

| #     | DESCRIPTION                        |
|-------|------------------------------------|
| 22.09 | FLOOR GRAIN - SLOPE FLOOR TO DRAIN |

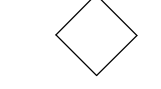
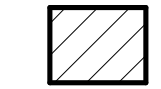
**LEGEND**

-  CONCRETE SLAB
-  TUBULAR CONCRETE FORM BLOCK-OUTS
-  RECESSED SLAB - SEE PLAN FOR ELEVATION
-  ELEVATOR PIT
-  2'-0" x 2'-0" x 2'-0" SUMP AT ELEVATOR PIT

**KEY PLAN**

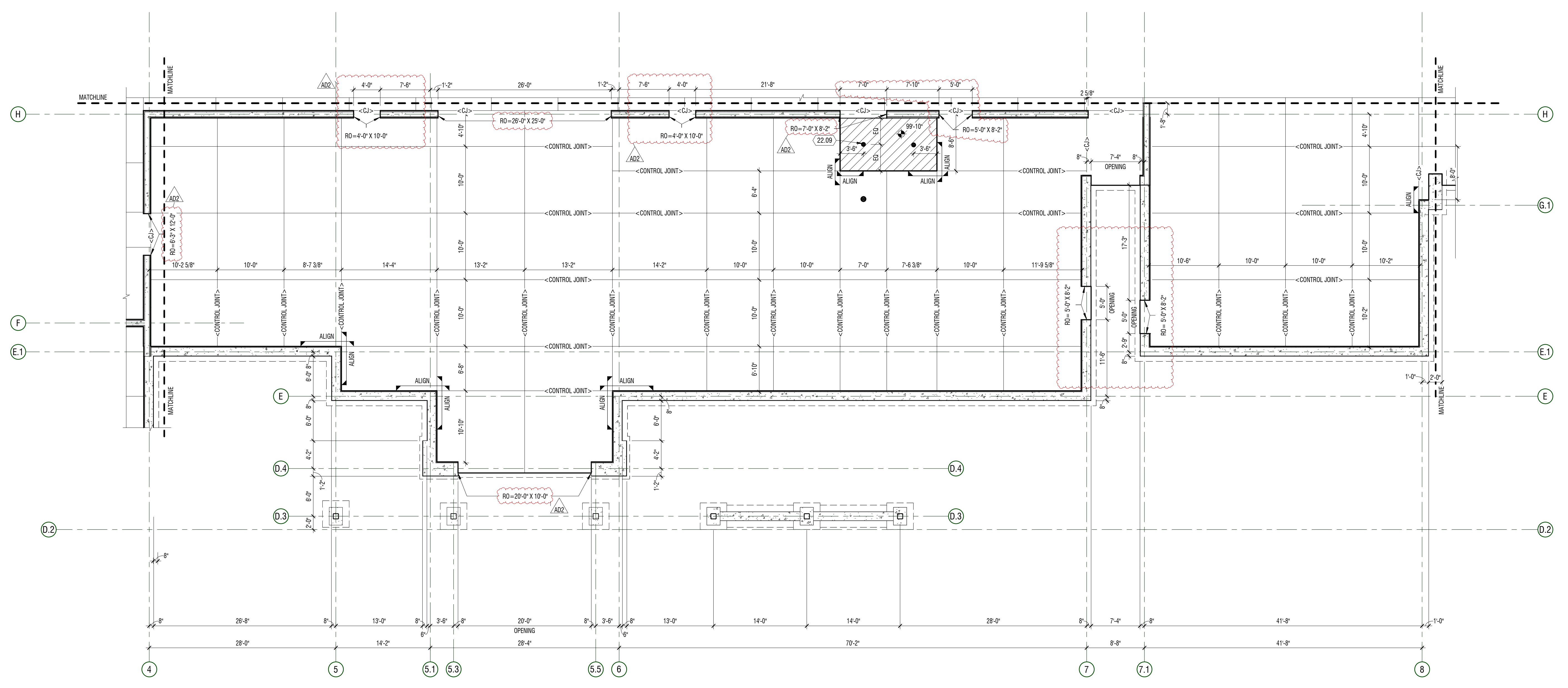
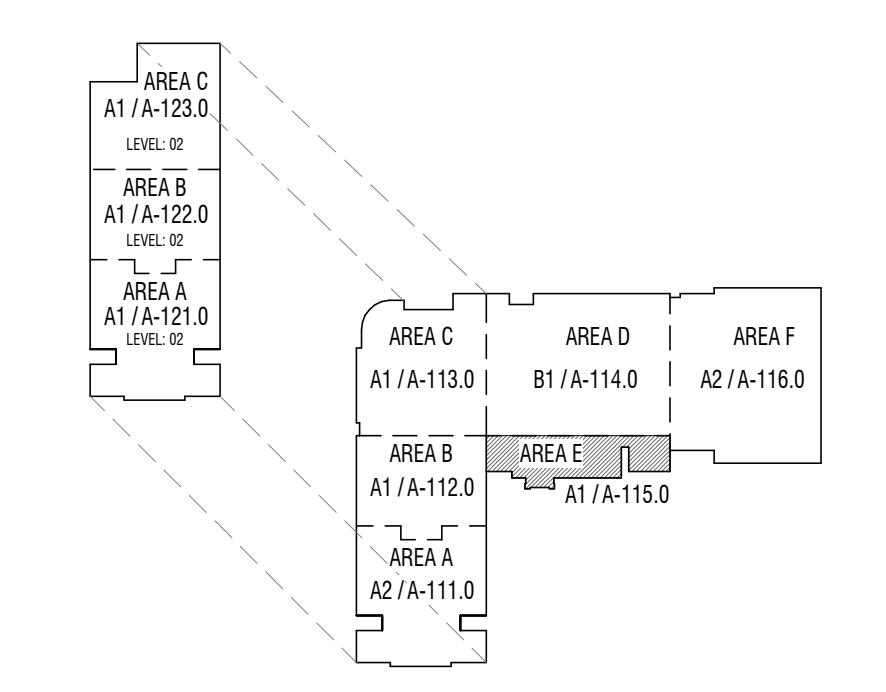

**A1 PLAN - SLAB**  
 1/8" = 1'-0"  
 AREA E - LEVEL 01

**CONSTRUCTION DOCUMENTS**

**NIBLEY MIDDLE SCHOOL**

3050 S 920 W IMBLEY, UTAH  
 CACHE COUNTY SCHOOL DISTRICT

| MARK | DATE        | DESCRIPTION                              |
|------|-------------|--|
| A102 | MAY 07 2024 | ADDITIONAL ICF BID PACKAGE 2 FOR RELEASE |

PROJECT #: 123006  
 DRAWN BY: LOYND  
 CHECKED BY: RIGBY  
 ISSUED: 05.02.2024

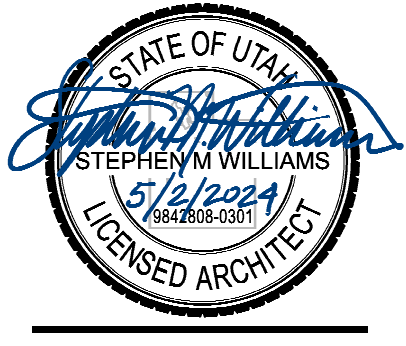

PLAN - LEVEL 01 -  
 AREA E - SLAB &  
 FOUNDATION

**A-115.0**

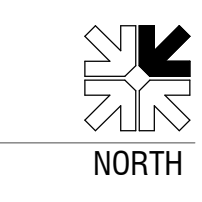

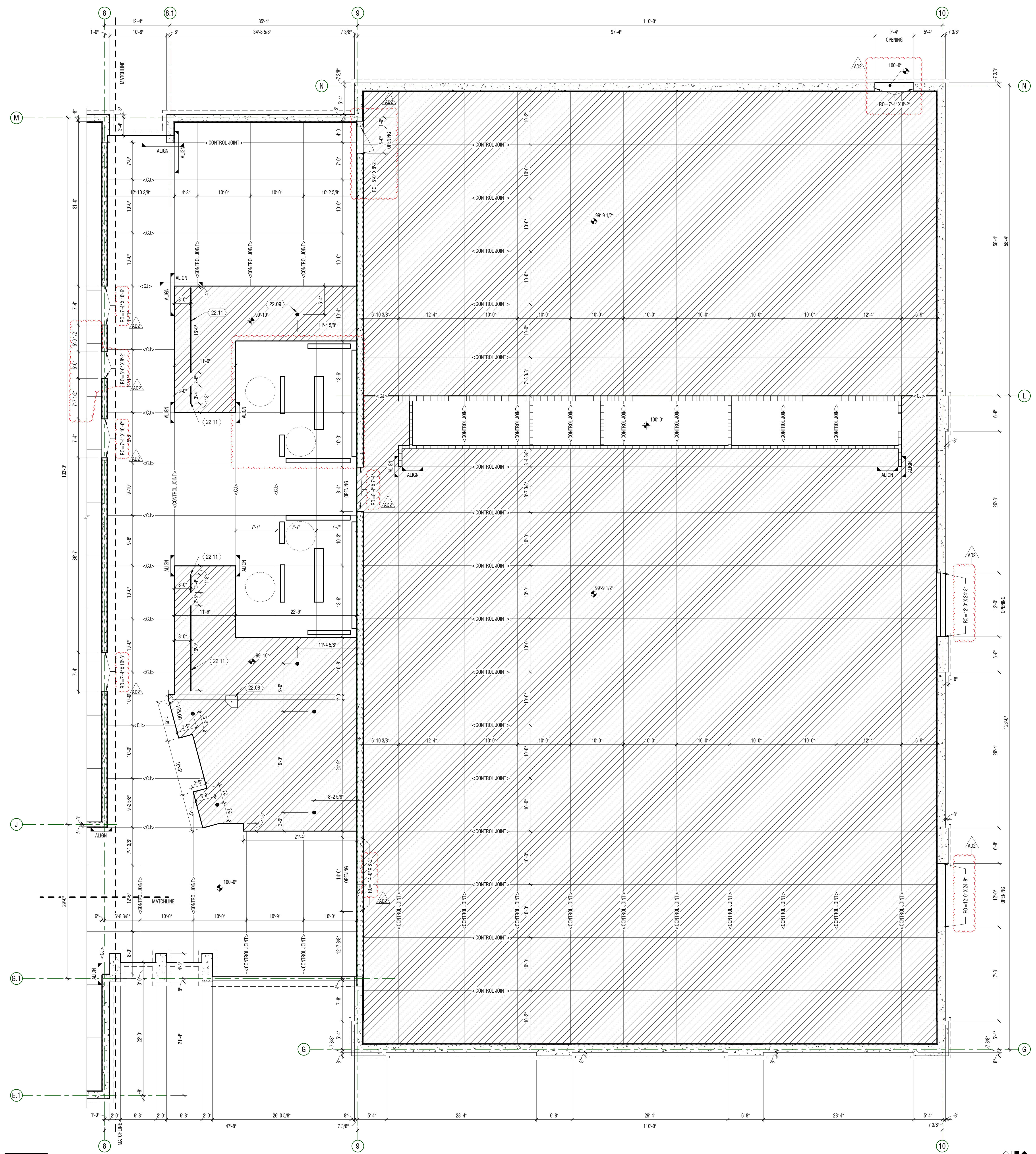

**A2 PLAN - SLAB**  
 1/8" = 1'-0" AREA F - LEVEL 01

**GENERAL NOTES**

- CONTRACTOR SHALL BE FAMILIARIZED WITH THE LAY-OUT OF STRUCTURAL, MECHANICAL, AND ELECTRICAL DRAWINGS. ANY QUESTIONS SHALL BE SUBMITTED VIA REQUEST FOR INFORMATION (RFI).
- DIMENSIONS ARE FROM GRID TO CENTERLINE OF COLUMN, DRAINS, ETC., U.N.O. AND EDGE OF ICF FOAM BLOCKS.
- COORDINATE WITH STRUCTURAL DRAWINGS FOR SIZE AND DEPTH OF FOOTING, METAL DECK, AND OTHER DETAILS.
- NOT ALL SLAB PENETRATIONS ARE SHOWN ON PLAN. COORDINATE WITH PLUMBING AND MECHANICAL DRAWINGS FOR ADDITIONAL DEVIATIONS.
- SLOPE ALL SETTING BEDS TO FLOOR DRAINS U.N.O.
- REVEAL TO OCCUR AT EXTERIOR GRADE. SEE BD PACKAGE 2 FOR PROFILE.
- ROUGH OPENINGS (RO) INDICATED AT ICF OPENINGS WITH X HEIGHT. SEE A11-A-578 FOR HOLLOW METAL DOOR FRAMING STANDARDS. FIELD VERIFY ALL STOREFRONT OPENINGS.

**KEYNOTES**

| #     | DESCRIPTION                        |
|-------|------------------------------------|
| 22.08 | MOP SINK                           |
| 22.09 | FLOOR DRAIN - SLOPE FLOOR TO DRAIN |
| 22.11 | LINEAR TRENCH DRAIN                |

**LEGEND**

- CONCRETE SLAB
- TUBULAR CONCRETE FORM BLOCK-OUTS
- RECESSED SLAB - SEE PLAN FOR ELEVATION
- ELEVATOR PIT
- 2'-0" x 2'-0" x 2'-0" SUMP AT ELEVATOR PIT

**KEY PLAN**

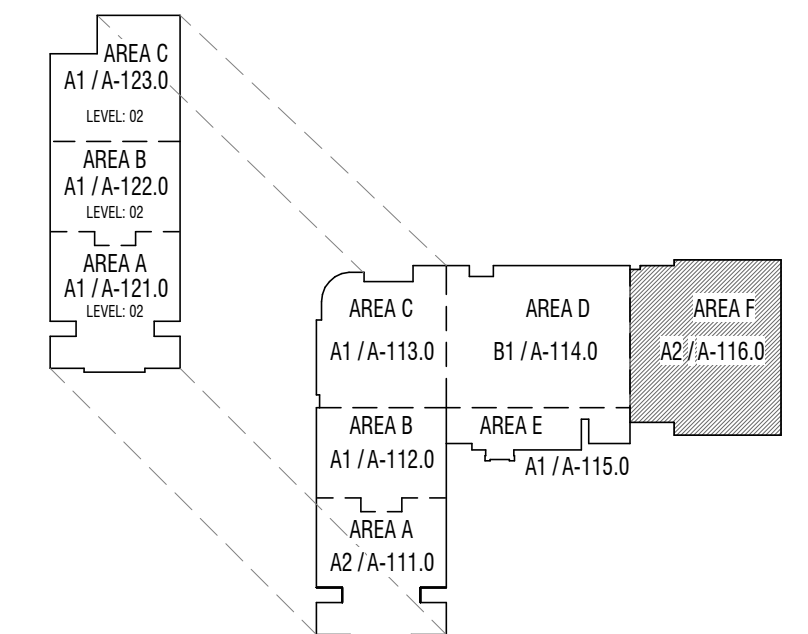

| MARK | DATE        | DESCRIPTION                                |
|------|-------------|--|
| A102 | MAY 07 2024 | ADDITIONAL ICF - BID PACKAGE 2 FOR RELEASE |

PROJECT #: 123006  
 DRAWN BY: LOYND  
 CHECKED BY: RIGBY  
 ISSUED: 05.02.2024

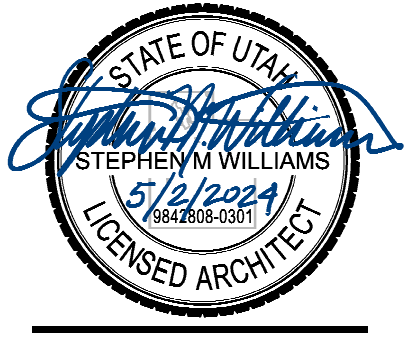

PLAN - LEVEL 01  
 AREA F - SLAB & FOUNDATION





**NMS ADDENDUM #2**

---

**DATE:** May 10, 2024

---

**TO:** **Michael Rigby**  
Design West Architects  
255 South 300 West  
Logan UT, 84321

435.754.9366 C  
435.752.7031 T

---

**FROM:** **Jeremy Jensen**  
Cache-Landmark Engineering  
95 Golf Course Rd, Suite 101  
Logan, UT 84321

435.770.3441 C  
435.713.0099 T  
jjensen@cachelandmark.com

---

**PROJECT:** Nibley Middle School

---

**SUBJECT:** Addendum #2 – Changes to Bid Package #1

---

**The following changes have been made to Bid Package #1 and are shown on Bid Package #2:**

1. **Civil – Roadway Plan & Profile – 3020 S / 920 West, Sheet C-601.**
  - a. **CHANGED** – Elevation for TBC match at northwest area of roundabout based on elevation adjustments made for control points.
  - b. **CHANGED** – Elevations for Roundabout Island based on change to TBC match point.  
(These elevation changes have already been included in the files sent to SUNROC for use in creating their GPS models)

**The following changes have been made to Bid Package #1 based on municipal comments that were provided after Bid Package #2 was issued and are shown on the attached sheets:**

2. **Civil – Utility Plan, Sheet C-301.**
  - a. **CHANGED** – Location of monitoring manhole adjusted to prevent contamination from 6” sewer line (human waste).
  - b. **CHANGED** – Elevations of grate and pipes for monitoring manhole.
  - c. **CHANGED** – Location of grease interceptor adjusted to accommodate change to monitoring manhole.
  - d. **ADDED** – 4” into 6” WYE connection at previous monitoring manhole location.
  - e. **ADDED** – Sewer line cleanout upstream of WYE connection.

Addendum #2 is hereby issued on May 10, 2024  
Cache-Landmark Engineering



Jeremy Jensen E.I.T.  
Project Manager

Attachment – Civil Sheets

---

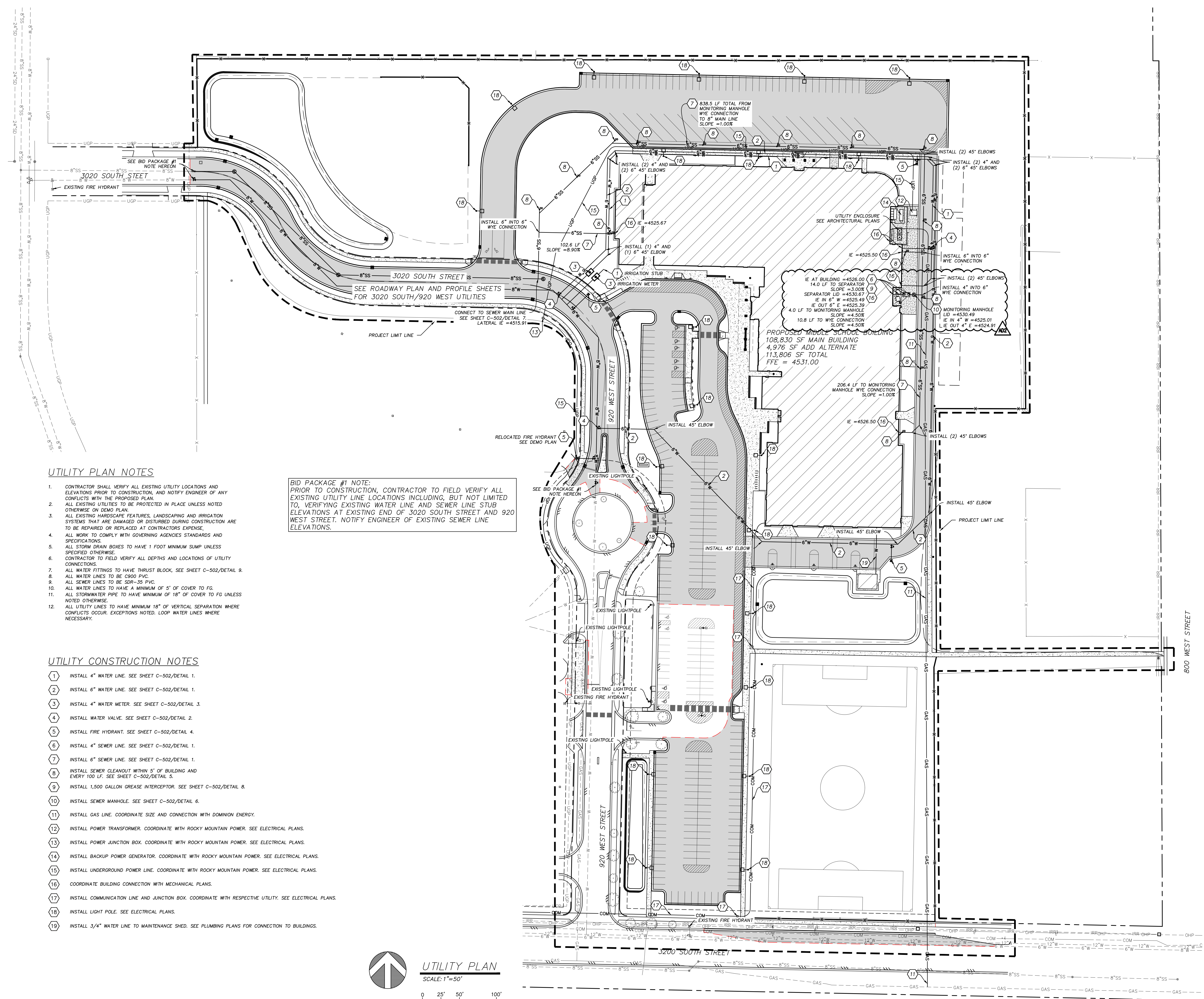

**UTILITY PLAN NOTES**

- CONTRACTOR SHALL VERIFY ALL EXISTING UTILITY LOCATIONS AND ELEVATIONS PRIOR TO CONSTRUCTION, AND NOTIFY ENGINEER OF ANY CONFLICTS WITH THE PROPOSED PLAN.
- ALL EXISTING UTILITIES TO BE PROTECTED IN PLACE UNLESS NOTED OTHERWISE ON DEMO PLAN.
- ALL EXISTING HARDSCAPE FEATURES, LANDSCAPING AND IRRIGATION SYSTEMS THAT ARE DAMAGED OR DISTURBED DURING CONSTRUCTION ARE TO BE REPAIRED OR REPLACED AT CONTRACTORS EXPENSE.
- ALL WORK TO COMPLY WITH GOVERNING AGENCIES STANDARDS AND SPECIFICATIONS.
- ALL STORM DRAIN BOXES TO HAVE 1 FOOT MINIMUM SUMP UNLESS SPECIFIED OTHERWISE.
- CONTRACTOR TO FIELD VERIFY ALL DEPTHS AND LOCATIONS OF UTILITY CONNECTIONS.
- ALL WATER FITTINGS TO HAVE THRUST BLOCK, SEE SHEET C-502/DETAIL 9.
- ALL WATER LINES TO BE C900 PVC.
- ALL SEWER LINES TO BE 309-35 PVC.
- ALL WATER LINES TO HAVE A MINIMUM OF 5' OF COVER TO FG.
- ALL STORMWATER PIPE TO HAVE MINIMUM OF 18" OF COVER TO FG UNLESS NOTED OTHERWISE.
- ALL UTILITY LINES TO HAVE MINIMUM 18" OF VERTICAL SEPARATION WHERE CONFLICTS OCCUR. EXCEPTIONS NOTED. LOOP WATER LINES WHERE NECESSARY.

**BID PACKAGE #1 NOTE:**  
 PRIOR TO CONSTRUCTION, CONTRACTOR TO FIELD VERIFY ALL EXISTING UTILITY LINE LOCATIONS INCLUDING, BUT NOT LIMITED TO, VERIFYING EXISTING WATER LINE AND SEWER LINE STUB ELEVATIONS AT EXISTING END OF 3020 SOUTH STREET AND 920 WEST STREET. NOTIFY ENGINEER OF EXISTING SEWER LINE ELEVATIONS.

**UTILITY CONSTRUCTION NOTES**

- INSTALL 4" WATER LINE. SEE SHEET C-502/DETAIL 1.
- INSTALL 6" WATER LINE. SEE SHEET C-502/DETAIL 1.
- INSTALL 4" WATER METER. SEE SHEET C-502/DETAIL 3.
- INSTALL WATER VALVE. SEE SHEET C-502/DETAIL 2.
- INSTALL FIRE HYDRANT. SEE SHEET C-502/DETAIL 4.
- INSTALL 4" SEWER LINE. SEE SHEET C-502/DETAIL 1.
- INSTALL 6" SEWER LINE. SEE SHEET C-502/DETAIL 1.
- INSTALL SEWER CLEANOUT WITHIN 5' OF BUILDING AND EVERY 100 LF. SEE SHEET C-502/DETAIL 5.
- INSTALL 1,500 GALLON GREASE INTERCEPTOR. SEE SHEET C-502/DETAIL 8.
- INSTALL SEWER MANHOLE. SEE SHEET C-502/DETAIL 6.
- INSTALL GAS LINE. COORDINATE SIZE AND CONNECTION WITH DOMINION ENERGY.
- INSTALL POWER TRANSFORMER. COORDINATE WITH ROCKY MOUNTAIN POWER. SEE ELECTRICAL PLANS.
- INSTALL POWER JUNCTION BOX. COORDINATE WITH ROCKY MOUNTAIN POWER. SEE ELECTRICAL PLANS.
- INSTALL BACKUP POWER GENERATOR. COORDINATE WITH ROCKY MOUNTAIN POWER. SEE ELECTRICAL PLANS.
- INSTALL UNDERGROUND POWER LINE. COORDINATE WITH ROCKY MOUNTAIN POWER. SEE ELECTRICAL PLANS.
- COORDINATE BUILDING CONNECTION WITH MECHANICAL PLANS.
- INSTALL COMMUNICATION LINE AND JUNCTION BOX. COORDINATE WITH RESPECTIVE UTILITY. SEE ELECTRICAL PLANS.
- INSTALL LIGHT POLE. SEE ELECTRICAL PLANS.
- INSTALL 3/4" WATER LINE TO MAINTENANCE SHED. SEE PLUMBING PLANS FOR CONNECTION TO BUILDINGS.

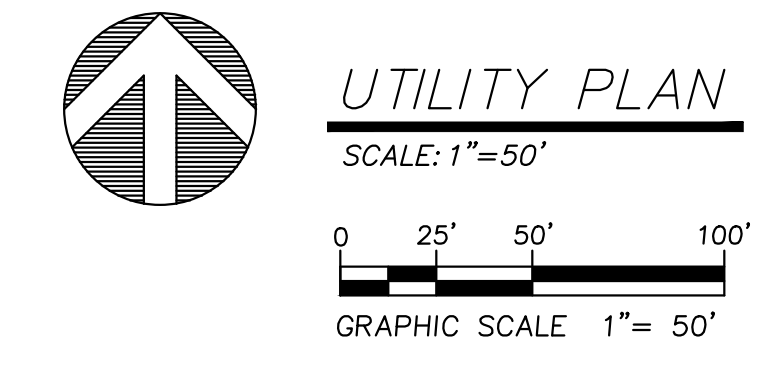

| MARK | DATE | DESCRIPTION |
|------|------|-------------|
|      |      |             |
|      |      |             |
|      |      |             |
|      |      |             |
|      |      |             |
|      |      |             |
|      |      |             |
|      |      |             |
|      |      |             |
|      |      |             |

PROJECT #: 123005  
 DRAWN BY: J. JENSEN  
 CHECKED BY: L. ANDERSON  
 ISSUED: 05.02.2024

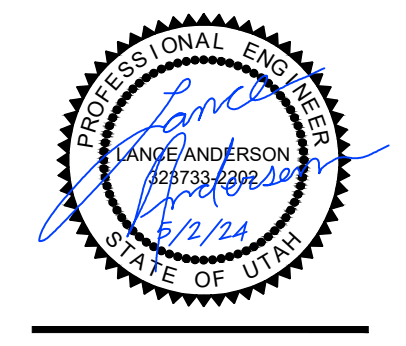

**CONSTRUCTION DOCUMENTS**

| MARK | DATE | DESCRIPTION |
|------|------|-------------|
|      |      |             |
|      |      |             |
|      |      |             |
|      |      |             |
|      |      |             |
|      |      |             |
|      |      |             |
|      |      |             |
|      |      |             |

PROJECT #: 123005  
 DRAWN BY: J. JENSEN  
 CHECKED BY: L. ANDERSON  
 ISSUED: 05.02.2024

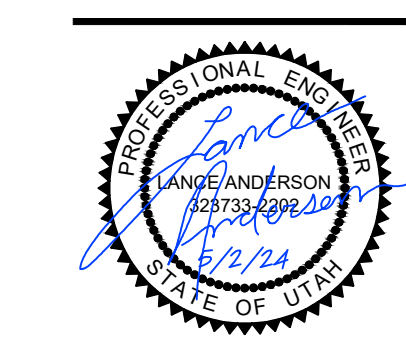

CIVIL - ROADWAY  
 PLAN & PROFILE  
 3020 S / 920 W

GENERAL NOTES

- ALL UTILITY LINES TO BE INSTALLED PER NIBLEY CITY STANDARDS.
- PLACE THURST BLOCKS PER NIBLEY CITY STANDARDS.
- WATER MAIN TO HAVE A MINIMUM COVER OF 5 FEET. FIRE HYDRANTS TO BE 6.5-FT BURY MINIMUM.
- PROVIDE TRACER WIRE ON ALL MAINS AND SERVICES PER NIBLEY CITY STANDARDS.
- ALL EXISTING HAROSCAPE FEATURES, LANDSCAPING AND IRRIGATION SYSTEMS THAT ARE DAMAGED OR DISTURBED DURING CONSTRUCTION ARE TO BE REPAIRED OR REPLACED AT CONTRACTORS EXPENSE.
- ALL IMPROVEMENTS TO COMPLY WITH ADA STANDARDS.
- ALL PAVEMENT MARKINGS TO CONFORM WITH THE LATEST EDITION OF THE MANUAL ON UNIFORM TRAFFIC CONTROL DEVICES (MUTCD).

CONSTRUCTION NOTES

- CONSTRUCT ASPHALT SECTION. SEE ROADWAY SECTION HEREON.
- CONSTRUCT 30" ROADWAY CURB & GUTTER. SEE SHEET C-501/DETAIL 4.
- CONSTRUCT CONCRETE SIDEWALK SECTION. SEE ROADWAY SECTION HEREON.
- CONSTRUCT ADA RAMP. SEE SHEET C-501.
- INSTALL 8" GATE VALVE ON WATER LINE.
- INSTALL 45' ELBOW.
- RELOCATE EXISTING FIRE HYDRANT TO 3' BEHIND PROPOSED SIDEWALK. SEE DEMO PLAN.
- INSTALL FIRE HYDRANT. SEE UTILITY PLAN.
- CONSTRUCT SPILL CURB & GUTTER. SEE SHEET C-501/DETAIL 4.
- CONSTRUCT ROLLED CURB & GUTTER. SEE SHEET C-501/DETAIL 5.

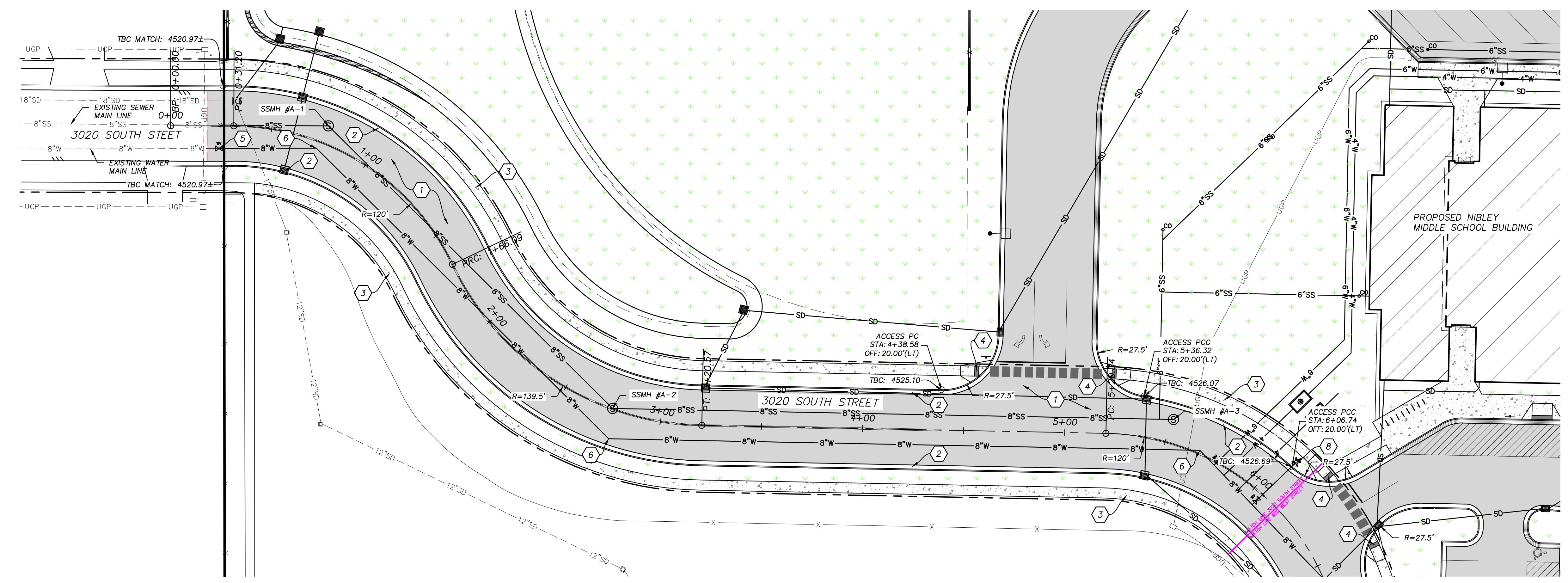

3020 SOUTH STREET PLAN VIEW  
 SCALE: 1"=30'

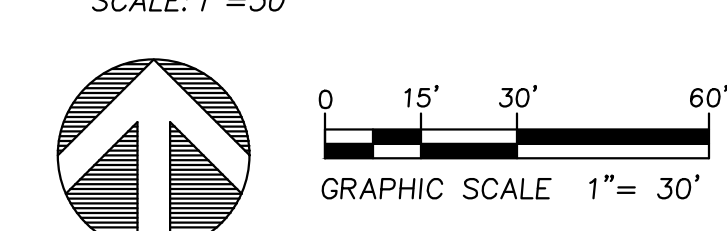

BID PACKAGE #1 NOTE:  
 PRIOR TO CONSTRUCTION, CONTRACTOR TO FIELD VERIFY ALL EXISTING UTILITY LINE LOCATIONS INCLUDING, BUT NOT LIMITED TO, VERIFYING EXISTING WATER LINE AND SEWER LINE STUB ELEVATIONS AT EXISTING END OF 3020 SOUTH STREET AND 920 WEST STREET. NOTIFY ENGINEER OF EXISTING SEWER LINE ELEVATIONS.

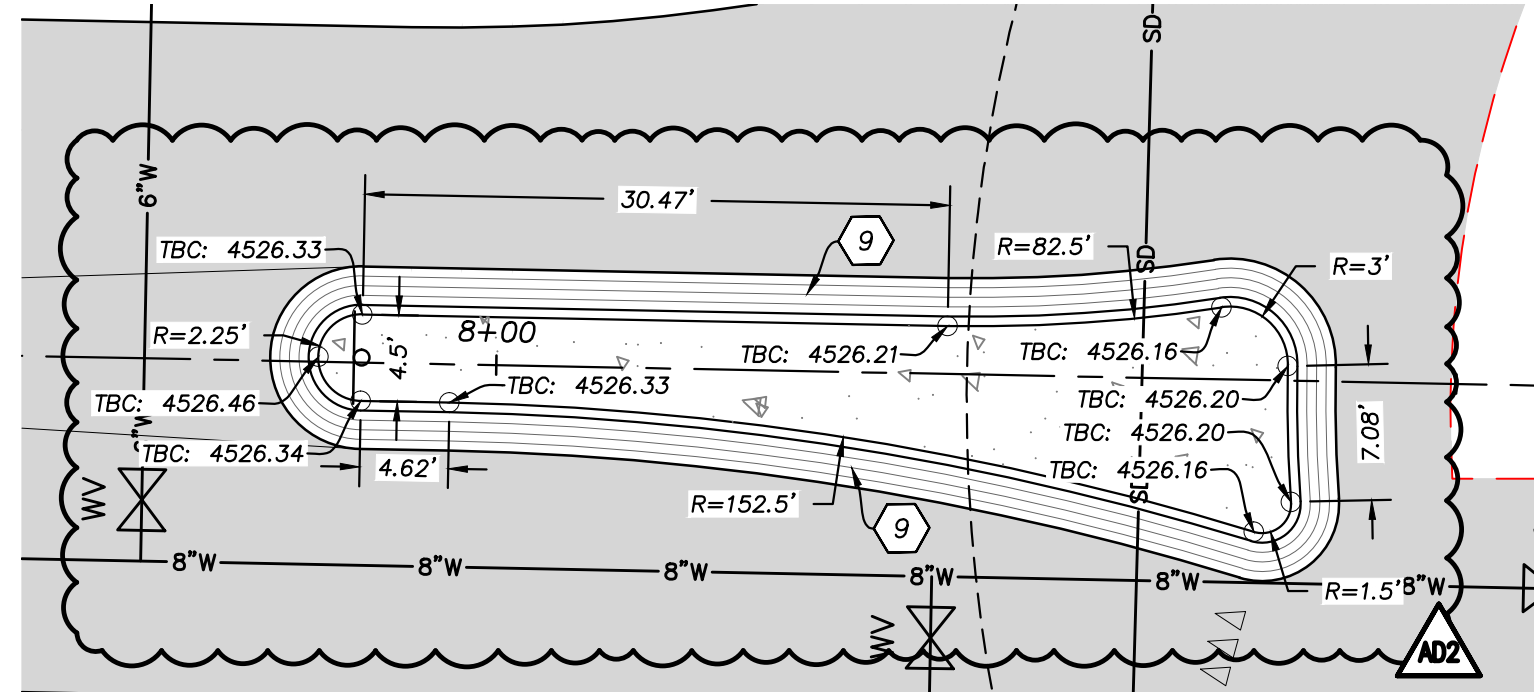

ROUNDABOUT ISLAND  
 SCALE: 1"=10'

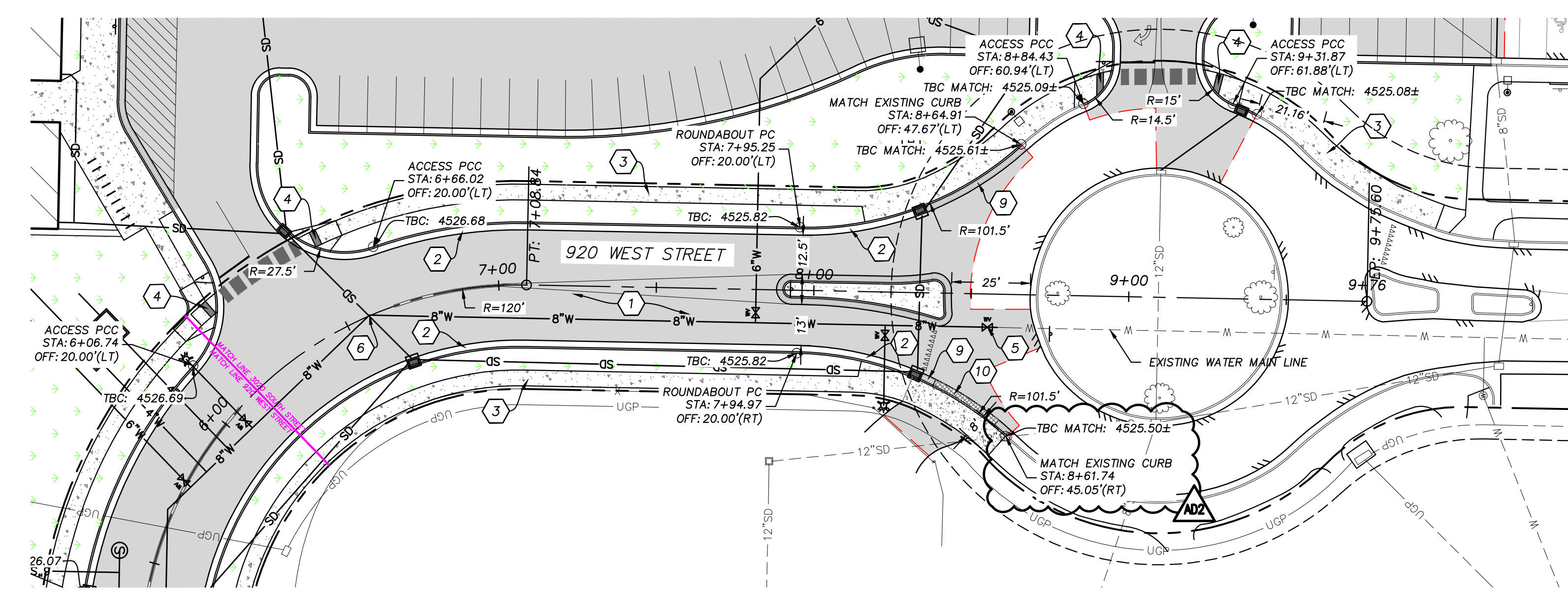

920 WEST STREET PLAN VIEW  
 SCALE: 1"=30'

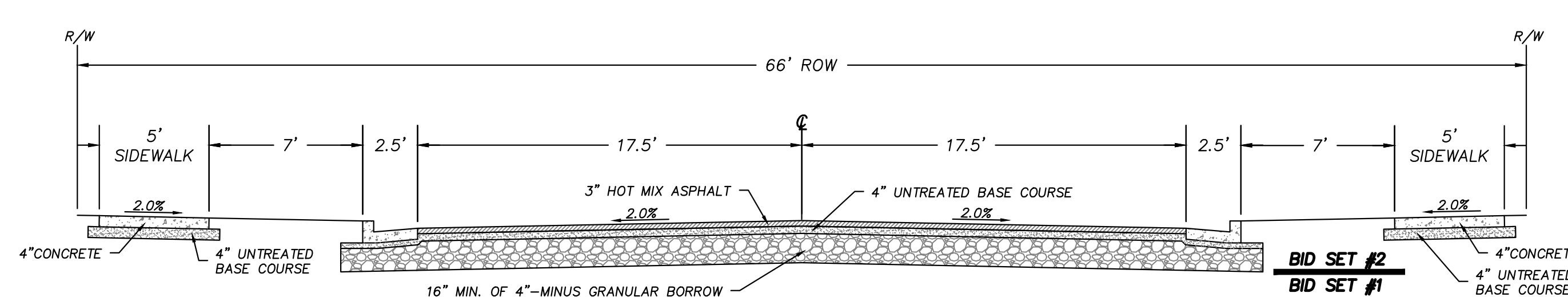

66' ROW ROADWAY SECTION  
 SCALE: NTS

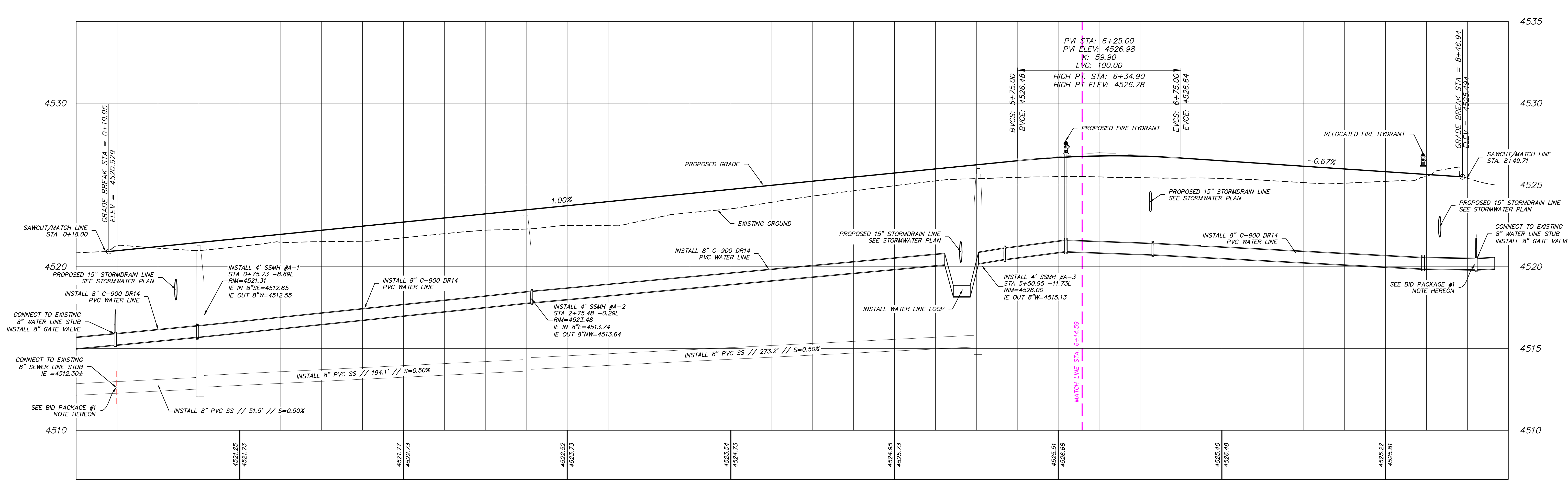

ROADWAY PROFILE VIEW  
 SCALE: H: 1"=30' V: 1"=3'

CONSTRUCTION DOCUMENTS



## MEMORANDUM

Project: CCSD Middle Schools

Project No: 23914

Location: Cache County, UT

Date: 5/7/2024

Telephone

Conference

Field

Memo

Memo by: Josh Blazzard, SE

RE: Addendum 2

Comments/Items Discussed:

Below is a description of items contained in Addendum #2:

**Sheet S-112:**

- 1) Two column and footing locations were adjusted slightly to match architectural drawings.
- 2) Additional potential foundation penetrations ("FP") locations were noted.

**Sheet S-113:**

- 1) The mechanical yard footings were revised.
- 2) Additional potential foundation penetrations ("FP") locations were noted.
- 3) Door location revisions have been shown.

**Sheet S-114:**

- 1) Additional potential foundation penetrations ("FP") locations were noted.

**Sheet S-115 and S-116:**

- 1) An additional concrete jamb was noted at the wall on grid 8.
- 2) Additional potential foundation penetrations ("FP") locations were noted.

**Sheet S-210:**

- 1) Detail 10 was revised to address changes to the screen wall around the mechanical yard.

Copy to: Design West Architects

Filing:  Project File  Other

23914\_Addendum 2 Narrative\_20240507.doc



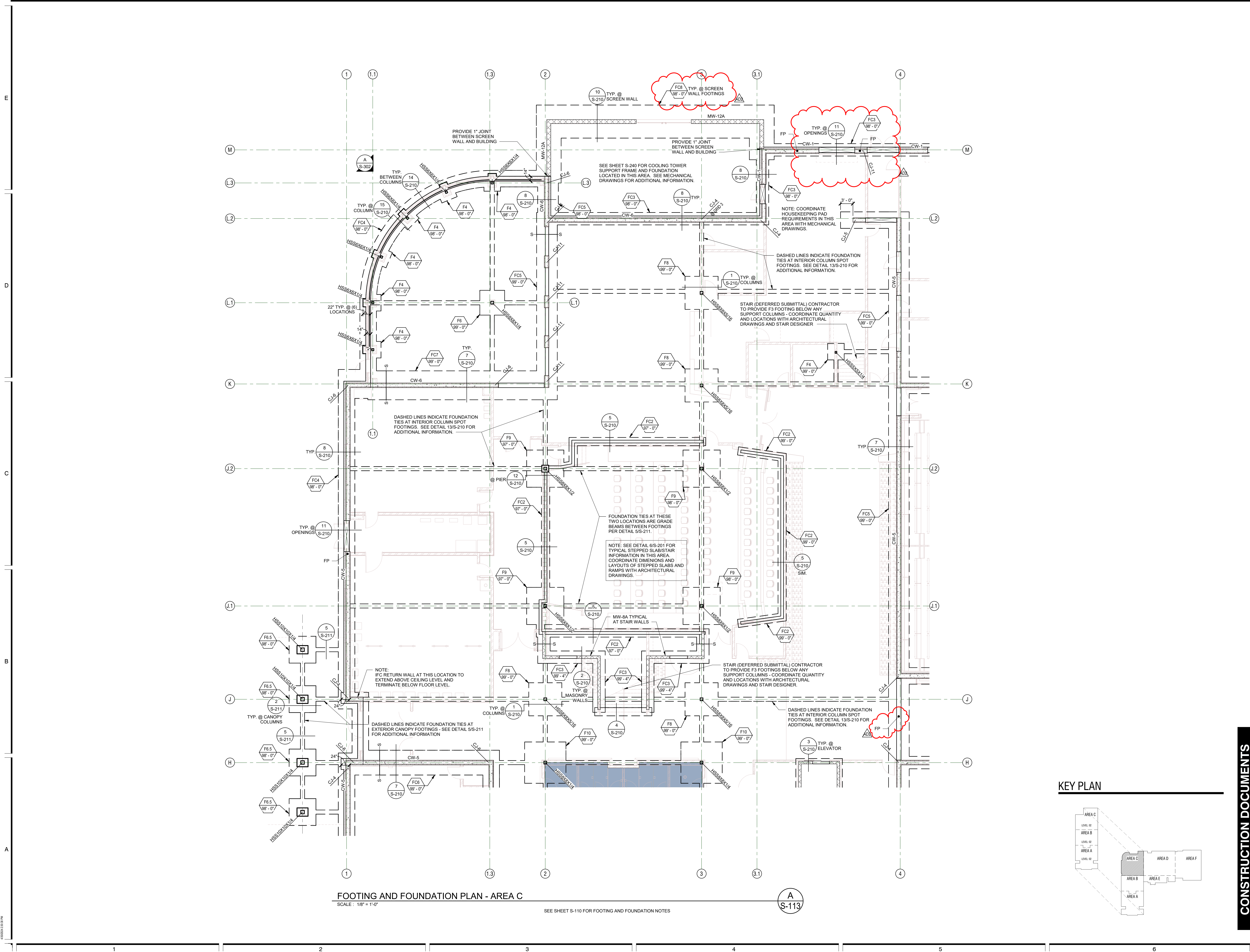

FOOTING AND FOUNDATION PLAN - AREA C  
SCALE: 1/8" = 1'-0"

SEE SHEET S-110 FOR FOOTING AND FOUNDATION NOTES

A  
S-113

**CONSTRUCTION DOCUMENTS**

| MARK | DATE     | DESCRIPTION |
|------|----------|-------------|
| AS2  | 05.02.24 |             |

PROJECT #: 123006  
DRAWN BY: BLP  
CHECKED BY: J. Blizard  
ISSUED: 05.02.2024



FOOTING AND FOUNDATION PLAN - AREA C

**S-113**

© COPYRIGHT DESIGN WEST ARCHITECTS 2024

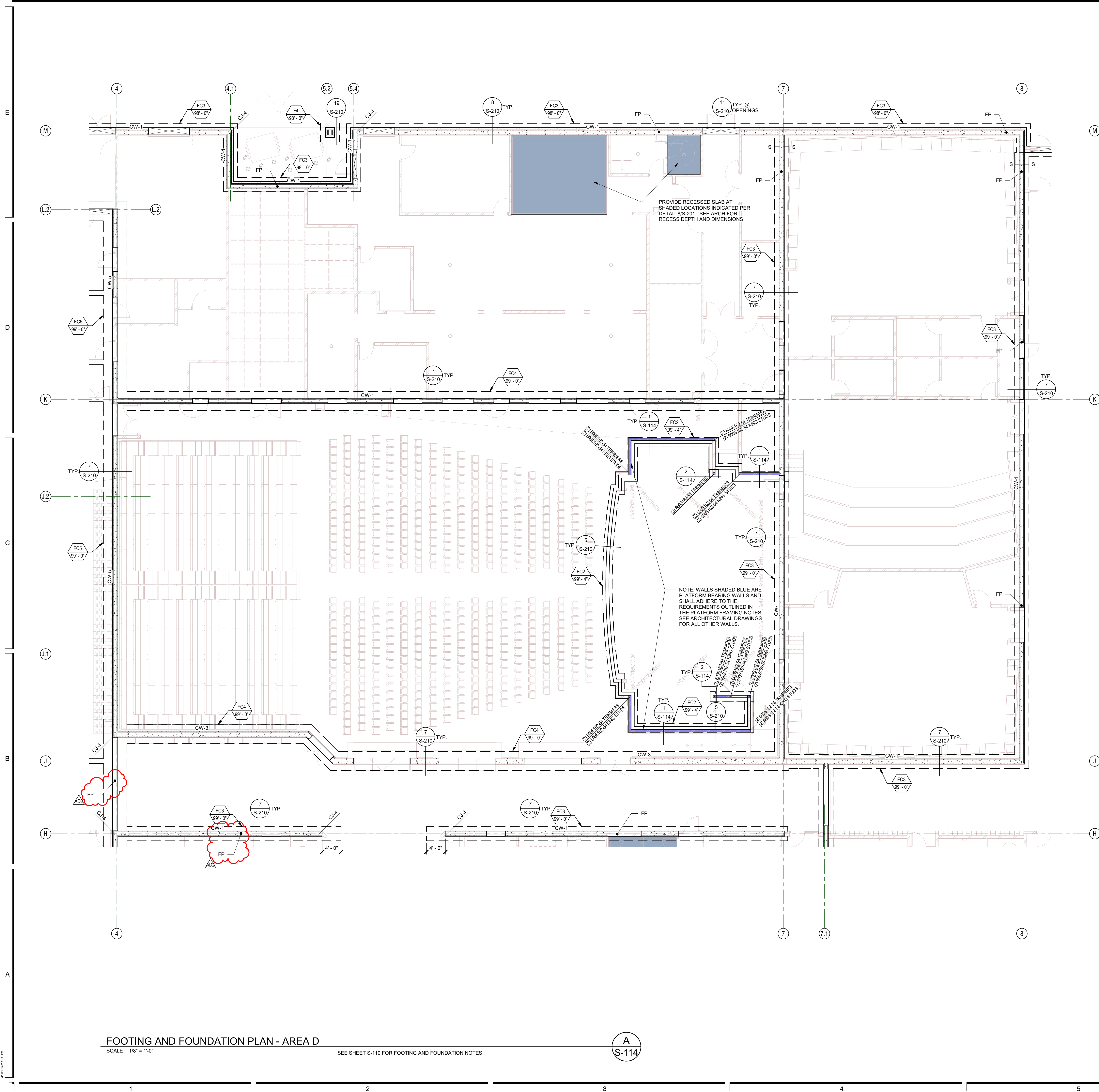

- PLATFORM FRAMING NOTES**
- LIGHT GAUGE STEEL FRAMING
    - STEEL FRAMING SIZE DESIGNATORS USED IN THE DRAWINGS FOLLOW THE CONVENTION ESTABLISHED BY THE STEEL STUD MANUFACTURERS ASSOCIATION (SSMA) AND THE NORTH AMERICAN STEEL FRAMING ALLIANCE (NASFA). FRAMING MEMBERS PROVIDED SHALL MEET OR EXCEED ALL SSMA AND NASFA STANDARDS AND DESIGN PROPERTIES.
    - ALL LOAD BEARING STUDS (AND/OR) JOIST FRAMING MEMBERS ALONG WITH ALL RUNNERS, BRIDGING, AND END TRACKS SHALL BE OF THE DESIGNATION SHOWN ON THE PLANS. ALL OF THE ABOVE ELEMENTS SHALL BE FORMED FROM STEEL MEETING REQUIREMENTS OF ASTM A1017/A1017M/04. ALL COMPONENTS SHALL BE GALVANIZED. ALL COMPONENTS SHALL HAVE THE FOLLOWING YIELD STRESSES:
 

| COMPONENT               | BASE METAL THICKNESS | YIELD STRESS |
|-------------------------|----------------------|--------------|
| STUDS, TRACKS           | 33 & 43 MIL          | 33,000 PSI   |
|                         | 54, 68 & 97 MIL      | 50,000 PSI   |
| END CLOSURES & BRIDGING | 33, 43, 54 & 68 MIL  | 33,000 PSI   |
    - FOLLOW ALL MANUFACTURERS' RECOMMENDATIONS FOR THE USE OF THESE PRODUCTS.
    - UNLESS NOTED OTHERWISE, ALL WELDED CONNECTIONS SHALL BE IN ACCORDANCE WITH AWS D1.3 AND THE STRUCTURAL DETAILS. ALL WELDS SHALL BE COMPLETED USING E60XX ELECTRODES.
  - SHEATHING SHALL BE APA RATED SHEATHING, EXPOSURE 1, EXTERIOR GLUE AND PANEL INDEX RATING AS NOTED BELOW UNLESS NOTED OTHERWISE:
 

| FLOOR | THICKNESS | PANEL INDEX |
|-------|-----------|-------------|
| 19/27 | 19/27     | 32/16       |
  - CONNECTIONS AND FASTENERS
    - THE HEAD OF ALL SCREWS SHALL BE SCREWED FLUSH WITH THE SURFACE OF THE SHEATHING.
    - ALL SCREWS SHALL HAVE THE FOLLOWING MINIMUM PROPERTIES:
 

| SCREW SIZE | SHANK DIAMETER | HEAD DIAMETER |
|------------|----------------|---------------|
| NO. 6      | 0.138"         | 0.272"        |
| NO. 8      | 0.164"         | 0.272"        |
| NO. 10     | 0.190"         | 0.340"        |
| NO. 12     | 0.216"         | 0.340"        |
    - UNLESS NOTED OTHERWISE, ALL FRAMING ANCHORS, CLIPS, HOLD DOWNS, STRAPS, ETC. TO BE PROVIDED BY THE STEEL NETWORK OR APPROVED EQUAL.
    - UNLESS NOTED OTHERWISE, ALL EXTERIOR WALL BOTTOM TRACKS TO BE ANCHORED TO THE CONCRETE WITH HILTI KWIK-HUS-EZ 1/2"X2-1/2" EMBEDMENT ANCHOR BOLTS @ 16" O.C.
    - UNLESS NOTED OTHERWISE, ALL STEEL STUD JOISTS AND BOX HEADER COMPONENTS SHALL BE CONTINUOUS WITH NO SPLICES.
    - UNLESS NOTED OTHERWISE, ALL STEEL STUD WALLS SHALL BE CONTINUOUS BETWEEN TOP AND BOTTOM TRACKS WITH NO SPLICES.
    - UNLESS NOTED OTHERWISE, ALL STEEL STUD JOISTS AND BOX HEADER COMPONENTS SHALL BE CONTINUOUS WITH NO SPLICES BETWEEN BEARING SUPPORTS.
    - UNLESS NOTED OTHERWISE, ALL WALLS SHALL BE 600S162-54 STUDS SPACED AT 16" O.C. W/ 600T150-54 TRACKS. ATTACH TRACK TO STUDS W/ (1) #6 TEK SCREWS EACH SIDE OF STUD.

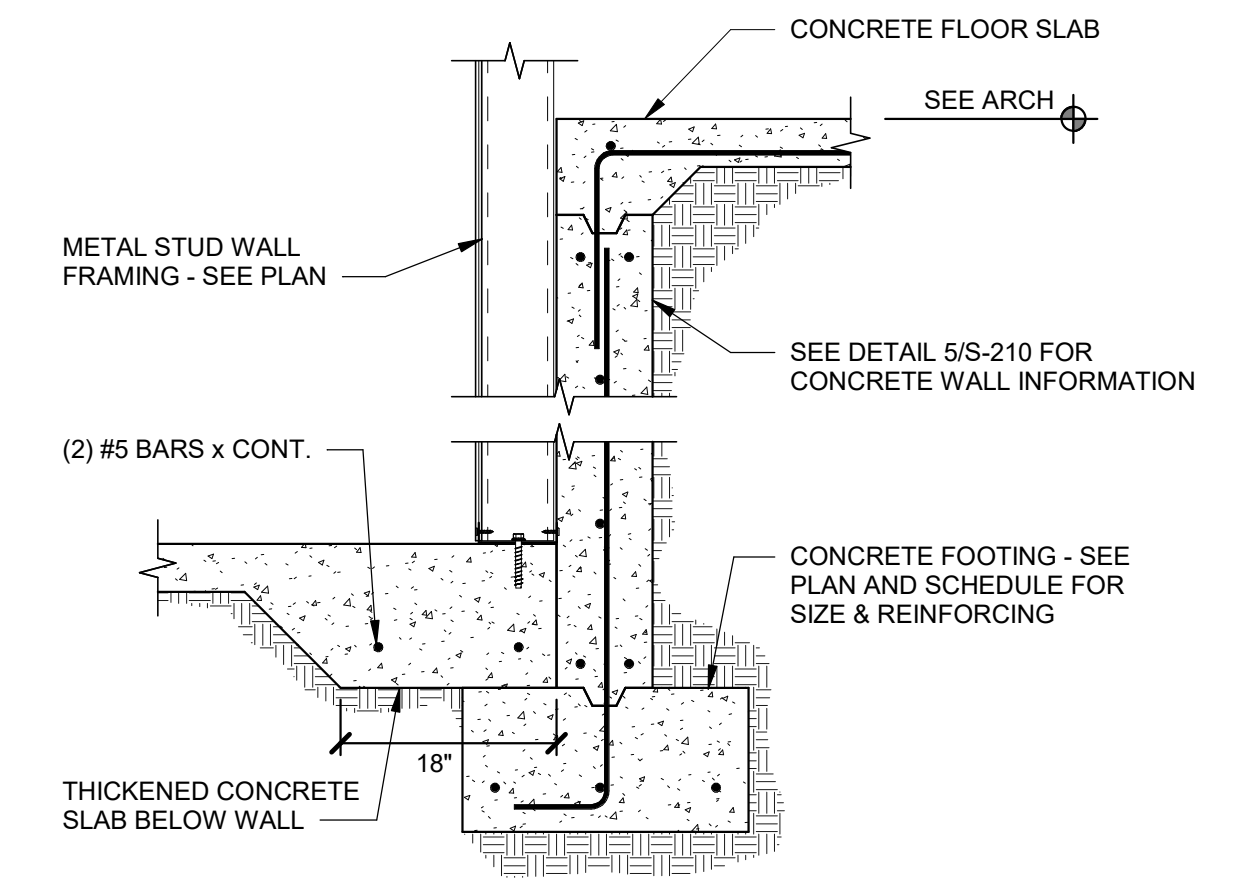

**DETAIL 1 S-114**  
SCALE: NONE

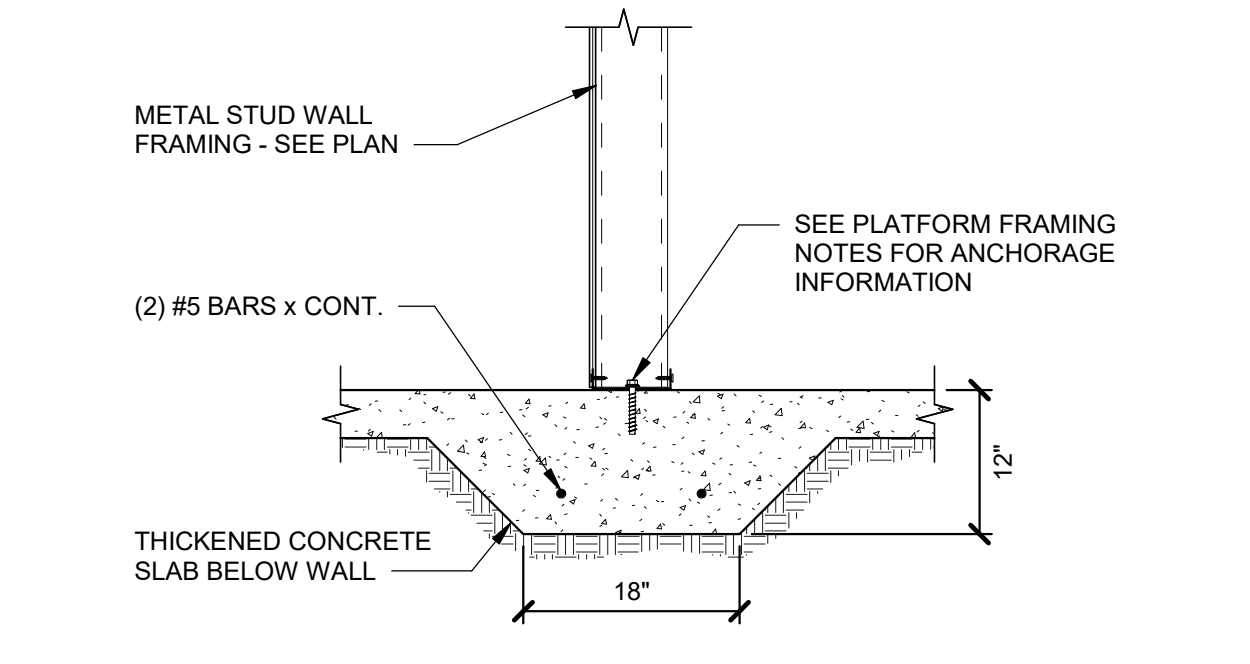

**DETAIL 2 S-114**  
SCALE: NONE

**KEY PLAN**

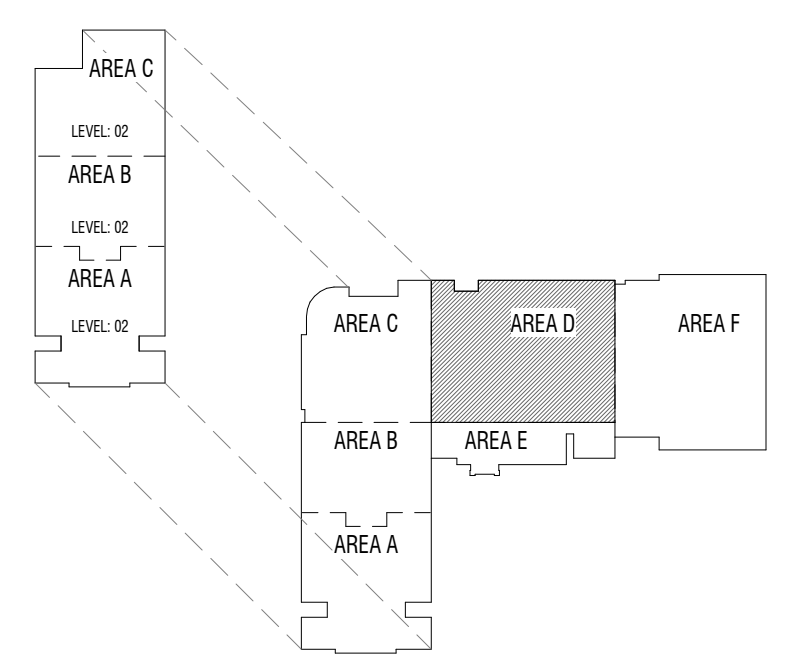

**FOOTING AND FOUNDATION PLAN - AREA D**  
SCALE: 1/8" = 1'-0"  
SEE SHEET S-110 FOR FOOTING AND FOUNDATION NOTES

A  
S-114

| MARK     | DATE | DESCRIPTION |
|----------|------|-------------|
| 05.02.24 | BLP  |             |

PROJECT #: 123006  
DRAWN BY: BLP  
CHECKED BY: J. Blizard  
ISSUED: 05.02.2024

