

1

2

3

4

5

6

E

D

C

B

A



1 AREA 6 - ELECTRICAL PLAN
 EP1.6 SCALE: 1/8"=1'-0"

- ### # KEYED NOTES
- ROUTE CIRCUIT. REFER TO EQUIPMENT SCHEDULE FOR SIZING REQUIREMENTS. TO BE CONNECTED TO A NEW 120V/20A/3P CIRCUIT BREAKER WITHIN EXISTING MAIN DISTRIBUTION PANEL HVDP.
 - REPLACE EXISTING WALL PACK FIXTURE WITH NEW FIXTURE SCHEDULED. REFER TO LIGHT FIXTURE SCHEDULE FOR MORE DETAIL.
 - PROVIDE ADDITIONAL 120V/1PH/20A CIRCUIT FOR EQUIPMENT HEATERS AND CONTROLS. REFER TO EQUIPMENT MANUFACTURERS INSTALLATION DETAILS FOR ADDITIONAL INFORMATION.
 - APPROXIMATE CONDUIT ROUTING FOR NEW CHILLER 'C-1'. REFER TO EQUIPMENT SCHEDULE FOR CONDUIT AND CONDUCTOR SIZING.
 - ROUTE CONDUIT AND CONDUCTORS. REFER TO EQUIPMENT SCHEDULE FOR MORE DETAIL. TO BE CONNECTED TO A NEW 90A/3P CIRCUIT BREAKER WITHIN EXISTING MAIN DISTRIBUTION PANEL HVDP. VFD AND UNISTRUT MOUNTING SYSTEM ARE TO BE PROVIDED BY MC.
 - PROVIDE (1) 120V/3P & (2) 70A/3P CIRCUIT BREAKERS WITH AIC RATINGS THAT MATCH EXISTING BREAKERS/GEAR.

- ### GENERAL NOTES
- EC SHALL COORDINATE WITH ALL OTHER TRADES DURING DEMOLITION AND CONSTRUCTION TO FACILITATE TIMELY WORK.
 - ALL AREAS ARE TO BE KEPT CLEAN AND CLEAR OF DEBRIS AT ALL TIMES.
 - CONTRACTOR SHALL PATCH AND REPAIR ALL WALLS, CEILING ETC. TO MATCH EXISTING CONDITIONS. PENETRATIONS SHALL BE SEALED WITH FIRE RATED CAULK.
 - ROUTE ALL CONDUIT IN A NEAT AND ORDERLY FASHION. ALL CONDUIT SHALL BE CONCEALED ABOVE CEILING OR IN WALLS IN FINISHED SPACES UNLESS OTHERWISE INDICATED ON THE PLANS.
 - EXISTING DEVICES SHOWN ON SHEETS ARE GATHERED FROM AS-BUILT DRAWINGS AND FIELD INVESTIGATION. NOT ALL DEVICES ARE SHOWN. DEVICE PLACEMENT IS SCHEMATIC AND NOT EXACT. CONTRACTOR TO FIELD VERIFY FOR EXACT LOCATIONS AND COORDINATE WORK WITH ALL OTHER DEVICES, EQUIPMENT, CONDUIT, ETC. WHETHER OR NOT SHOWN TO COMPLETE PROJECT.
 - DEVICES/EQUIPMENT SHOWN IN GRAY ARE EXISTING TO REMAIN. PRESERVE AND PROTECT. MAINTAIN EXISTING CIRCUIT INTEGRITY.
 - PROVIDE CLEAR, TYPED, P-TOUCH LABELS ON ALL NEW DEVICES/EQUIPMENT INDICATING THE PANEL AND CIRCUIT NUMBER IT IS TIED TO. LABEL SHALL BE 1/8" LONGER THAN TEXT ON BOTH ENDS.
 - PROVIDE UPDATED TYPED CIRCUIT DIRECTORY WITH UNIQUE CIRCUIT DESCRIPTIONS PER NEC 408.4 FOR PANELS AFFECTED BY THIS PROJECT.
 - ALL CORE DRILLING IS THE RESPONSIBILITY OF THE ELECTRICAL CONTRACTOR.



181 East 5600 South
 Murray, UT 84107
 801.530.3148 T
 801.530.3150 F

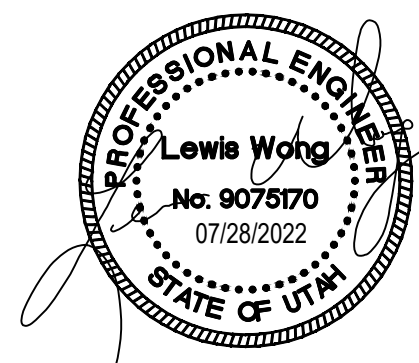

Original drawings remain the property of the Engineer and as such the Engineer retains total ownership and control. The design represented by these drawings are sold to the client for a one time use, unless otherwise agreed upon in writing by the Engineer.
 • Van Boerum & Frank Assoc., 2021

ADELE YOUNG INTERMEDIATE SCHOOL COOLING UPGRADE
 830 LAW DRIVE, BRIGHAM CITY, UTAH 84302

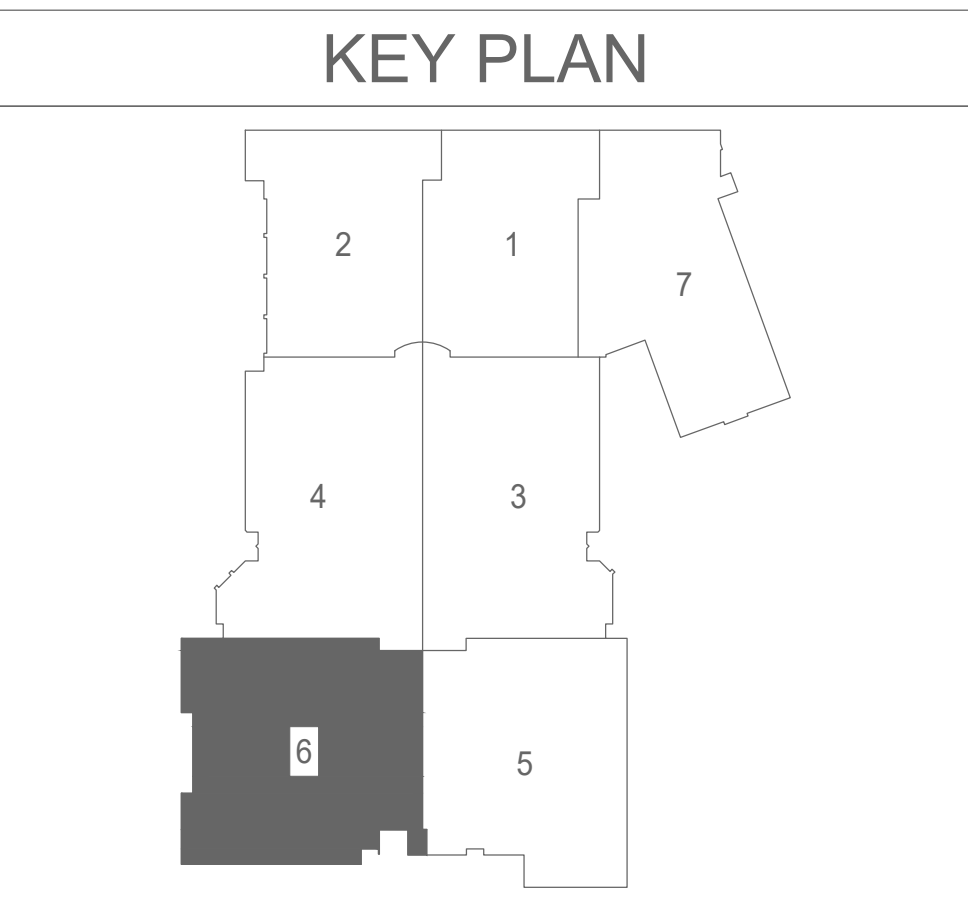

REVISIONS

VBFA PROJECT #:	21493
CHECKED BY:	KC
DRAWN BY:	AC
CURRENT/ISSUE DATE:	07.28.2022

SHEET CONTENTS
AREA 6 ELECTRICAL PLAN

EP1.6