



DFCM SOLICITATION ADDENDUM COVER PAGE

DFCM Addendum No.1

Date: July 20, 2023
To: Bidding Contractors
From: Carl Francis-DFCM Project Manager
Reference: Main Campus Meat Lab Freezer Floor Repairs
 DFCM Project 23462210

	<u>Pages</u>
Content: Addendum Cover Page	1
A/E Contract Addendum No. 1	1
Approved Stamped Plans-Addendum No. 1	2
Total Pages:	
	4

Note: This Addendum shall be included as part of the Contract Documents. Items in this Addendum apply to all drawings and specification sections whether referenced or not involving the portion of the work added, deleted, modified, or otherwise addressed in the Addendum. Acknowledge receipt of this Addendum in the space provided on the Bid Form. Failure to do so may subject the Bidder to Disqualification.

- 1.1 Schedule Changes:** There are no project schedule changes within this Addendum No .1
- 1.2 General Items:** AD1.0.1 G-001 COVER SHEET & PROJECT INFORMATION
 - 1. Added vicinity map
- 1.3 Architectural:** AD1.0.2 A-101 FLOOR PLAN, DEMOLITION PLAN & DETAILS
 - 1. Clarified floor components
 - a. PSI strength for concrete added
 - b. Specified tile to be installed with pattern layout
 - c. Added epoxy grout requirement
 - d. Added Welded Wire Fabric Mesh requirement to notes including size and placement.
 - e. Adjusted conduit sizing to 1" from ¾" to align with electrical requirement.
 - f. Specified MIL thickness of vapor barrier.
- 1.4 Electrical:** None
- 1.5 Attachments:** G-001 COVER SHEET & PROJECT INFORMATION
 A-101 FLOOR PLAN, DEMOLITION PLAN & DETAILS

CONTRACT ADDENDUM #1

date: 6/15/2023
project: BTech Meat Services
Freezer Floor Replacement
by: Stephen Williams
subject: Addendum 1

The Work shall be carried out in accordance with the following supplemental instructions issued in accordance with the Contract Documents. Prior to proceeding in accordance with these instructions, indicate your acceptance of these instructions for minor change to the work as consistent with the Contract Documents and return a copy to the Architect.

Items

General

AD1.0.1 G-001 COVER SHEET & PROJECT INFORMATION

1. Added vicinity map

Architectural

AD1.0.2 A-101 FLOOR PLAN, DEMOLITION PLAN & DETAILS

1. Clarified floor components
 - a. PSI strength for concrete added
 - b. Specified tile to be installed with pattern layout
 - c. Added epoxy grout requirement
 - d. Added Welded Wire Fabric Mesh requirement to notes including size and placement.
 - e. Adjusted conduit sizing to 1" from ¾" to align with electrical requirement.
 - f. Specified MIL thickness of vapor barrier.

Electrical

None

Attachments

G-001 COVER SHEET & PROJECT INFORMATION
A-101 FLOOR PLAN, DEMOLITION PLAN & DETAILS

Stephen M. Williams, AIA NCARB

ISSUED BY _____ Date _____
Architect

ACCEPTED BY _____ Date _____
Contractor

PROJECT INFORMATION

SHEET INDEX

DESIGN TEAM

OWNER

BRIDGERLAND TECHNICAL COLLEGE
1301 N 600 W
LOGAN, UT 84321
PHONE: 435.753.6780

PROJECT MANAGER

DFCM
CAPITAL HILL COMPLEX, 450 STATE ST SUITE 4110
SALT LAKE CITY, UT 84114
PHONE: 801.538.3018
jcfancis@utah.gov
CARL FRANCIS

ARCHITECT

DESIGN WEST ARCHITECTS
255 S 300 W
LOGAN, UT 84321
PHONE: 435.752.7031
stephenw@designwestarchitects.com
STEPHEN WILLIAMS

ELECTRICAL

SINE SOURCE ENGINEERING
95 GOLF COURSE RD
LOGAN, UT 84321
PHONE: 435.787.1445
ericr@sinesource.net
ERIC RASMUSSEN

NOTE: THE CONSTRUCTION DOCUMENTS FOR THIS PROJECT ARE COMPOSED OF SETS OF DRAWINGS AND SPECIFICATIONS, AND THEREFORE SHALL BE USED AND MAINTAINED IN THEIR ENTIRETY. ANY CONTRACTOR, SUBCONTRACTOR, VENDOR OR PARTY PARTICIPATING IN OR BIDDING ON THIS PROJECT SHALL BE EXPECTED TO PERFORM DUE DILIGENCE TO ENSURE THEIR BID, WORK PERFORMED, AND MATERIALS PROVIDED CONFORMS TO THE INFORMATION PROVIDED WITHIN ANY AND ALL SHEETS OF DRAWINGS AND SPECIFICATIONS, INCLUDING, BUT NOT LIMITED TO, ANY SUBSEQUENT ADDENDA OR CLARIFICATIONS THAT MAY BE ISSUED RELEVANT TO THEIR SCOPE OF WORK. PROJECT SCOPE MAY BE DEFINED WITHIN SPECIFICATIONS AND/OR DRAWINGS.

ADDITIONALLY, DRAWINGS MAY NOT BE RE-SCALED WHEN PRINTED, WRITTEN DIMENSIONS SHALL HAVE PRECEDENCE, AND LARGER SCALE DRAWINGS SHALL HAVE PRECEDENCE OVER SMALLER SCALE DRAWINGS.

ANY DEVIATION FROM OR CONFLICT WITHIN THE DRAWINGS AND/OR SPECIFICATIONS, MUST BE SUBMITTED VIA REQUEST FOR INFORMATION (RFI) AND RESPONDED TO BY THE ARCHITECT PRIOR TO BID OR BEFORE CONTINUING THAT PORTION OF WORK.

GENERAL:
G-001 COVER SHEET - PROJECT INFORMATION

ARCHITECTURAL:
A-101 FLOOR PLAN, DEMOLITION PLAN & DETAILS
A-601 SCHEDULE - FINISH

ELECTRICAL:
EE001 ABBREVIATIONS, G.P.N. LEGEND & SHEET INDEX
EE002 SPECIFICATION
EE101 ELECTRICAL POWER PLAN

ABBREVIATIONS

ABR.	DESCRIPTION	ABR.	DESCRIPTION	ABR.	DESCRIPTION
AB	ANCHOR BOLT	EXIST	EXISTING	PART BD	PARTICLE BOARD
ABS	ACRYLONITRILE-BUTADIENE -STYRENE	EXP	EXPANSION	PART'N	PARTITION
AC	ACOUSTIC, ACOUSTICAL	EXT	EXTERIOR	P-LAM	PLASTIC LAMINATE PLATE
ACC STA	ACCESSIBLE STATION	FD	FLOOR DRAIN	PLYWD	PLYWOOD
AD	ADDENDUM	FDN	FOUNDATION	PRFAB	PREFABRICATED
ADJ	ADJUSTABLE	FEC	FIRE EXTINGUISHER CABINET	PROJ	PROJECTION
AFF	ABOVE FINISH FLOOR	FIN	FINISH	PT	PRESERVATIVE TREATED
ALT	ALTERNATE	FLR	FLOOR	PVC	POLYVINYL CHLORIDE
ALUM	ALUMINUM	FTG	FOOTING	QT	QUARRY TILE
ASI	ARCHITECT SUPPLEMENTAL INSTRUCTION	GA	GAUGE	R/	ROUND
ASPH	ASPHALT	GALV	GALVANIZED	RAD	RADIUS
		GI	GALVANIZED IRON	RD	ROOF DRAIN
		GYP BD	GYP SUM BOARD	REF	REFRIGERATOR
		HDWD	HARDWOOD	REINF	REINFORCE
		HM	HOLLOW METAL	REV	REVISION
BB	BASKETBALL BOARD	HORIZ	HORIZONTAL	RFI	REQUEST FOR INFORMATION
BD	BOARD	HT	HEIGHT	RO	ROUGH OPENING
BLDG	BUILDING	ID	INSIDE DIAMETER	SCHED	SCHEDULE
BLKG	BLOCKING	INSUL	INSULATION	SHT	SHEET
BM	BENCH MARK	INT	INTERIOR	SIM	SIMILAR
B.O.	BOTTOM OF	JT	JOINT	SPEC	SPECIFICATION
BRG	BEARING	KD	KNOCK DOWN	SQ	SQUARE
BSMT	BASEMENT	KO	KNOCK OUT	SS	STAINLESS STEEL
B.U.R.	BUILT UP ROOF	L	ANGLE	STD	STANDARD
C	CHANNEL	LLV	LONG LEG VERTICAL	STL	STEEL
CB	CHALKBOARD	MAX	MAXIMUM	STOR	STORAGE
C	CENTER LINE	MB	MARKER BOARD	STRUCT	STRUCTURAL
CLG	CEILING	MECH	MECHANICAL	SUSP	SUSPENDED, SUSPENSION
CMU	CONCRETE MASONRY UNIT	MFR	MANUFACTURER	SYS	SYSTEM
CO	CLEAN OUT	MH	MANHOLE	T & B	TOP AND BOTTOM
COL	COLUMN	MIN	MINIMUM	TACK	TACKBOARD
CONC	CONCRETE	MISC	MISCELLANEOUS	TEMP	TEMPORARY
CONN	CONNECTION	MO	MASONRY OPENING	TEL	TELEPHONE
CONT	CONTINUOUS	MT	MOUNT	THRES	THRESHOLD
CONTR	CONTRACTOR	MTL	METAL	TS	TUBE STEEL
CT	CERAMIC TILE	(N)	NEW	T.O.	TOP OF
d	DIMENSION	NIC	NOT IN CONTRACT	TOIL	TOILET
DS	DOWNSPOUT	NTS	NOT TO SCALE	TV	TELEVISION
DWG	DRAWING	O.C.	ON CENTER	TYP	TYPICAL
(E)	EXISTING	OD	OUTSIDE DIAMETER	VERT	VERTICAL
EA	EACH	OH	OVERHEAD	UNLESS	UNLESS NOTED OTHERWISE
EIFS	EXTERIOR INSULATION FINISH SYSTEM	OF/CI	OWNER FURNISHED / CONTRACTOR INSTALLED	W	WIDE FLANGE
ELECT	ELECTRICAL	OF/OI	OWNER FURNISHED / OWNER INSTALLED	WITH	WITH
ELEV	ELEVATION	OPNG	OPENING	WC	WATER CLOSET
EQ	EQUAL	OPP	OPPOSITE	WD	WOOD
EQUIP	EQUIPMENT	O.T.S.	OPEN TO STRUCTURE	WM	WATER METER
EW	ELECTRIC WATER COOLER			W/O	WITHOUT
				WWF	WELDED WIRE FABRIC

SYMBOLS LEGEND

DESCRIPTION	SYMBOL	DESCRIPTION	SYMBOL
BUILDING SECTION		DRAWING TAG	
WALL SECTION		WINDOW TYPES	
DETAIL		WALL TYPES	
SECTION DETAIL ENLARGED PLAN		DOOR TAG	
ELEVATION LEVEL		KEYNOTES	
ELEVATIONS		REVISIONS	
ROOM TAG		GRID BUBBLE	
ROOM FINISH TAG		EQUIPMENT TAG	
		FINISH TAG	
		NORTH ARROW	

MATERIALS LEGEND

MATERIAL	SYMBOL
EARTH	
ASPHALT PAVING	
COMPACTED GRANULAR FILL	
CONCRETE	
CONCRETE MASONRY UNITS	
BRICK	
STEEL	
CONTINUOUS WOOD	
WOOD BLOCKING	
PLYWOOD / OSB	
PARTICLE BOARD	
INSULATION	
RIGID INSULATION	
GYP SUM BOARD	
GLU-LAMINATE BEAM	
GLASS	
FINISH WOOD	
ALUMINUM	
WOOD STUD WALL	

VICINITY MAP

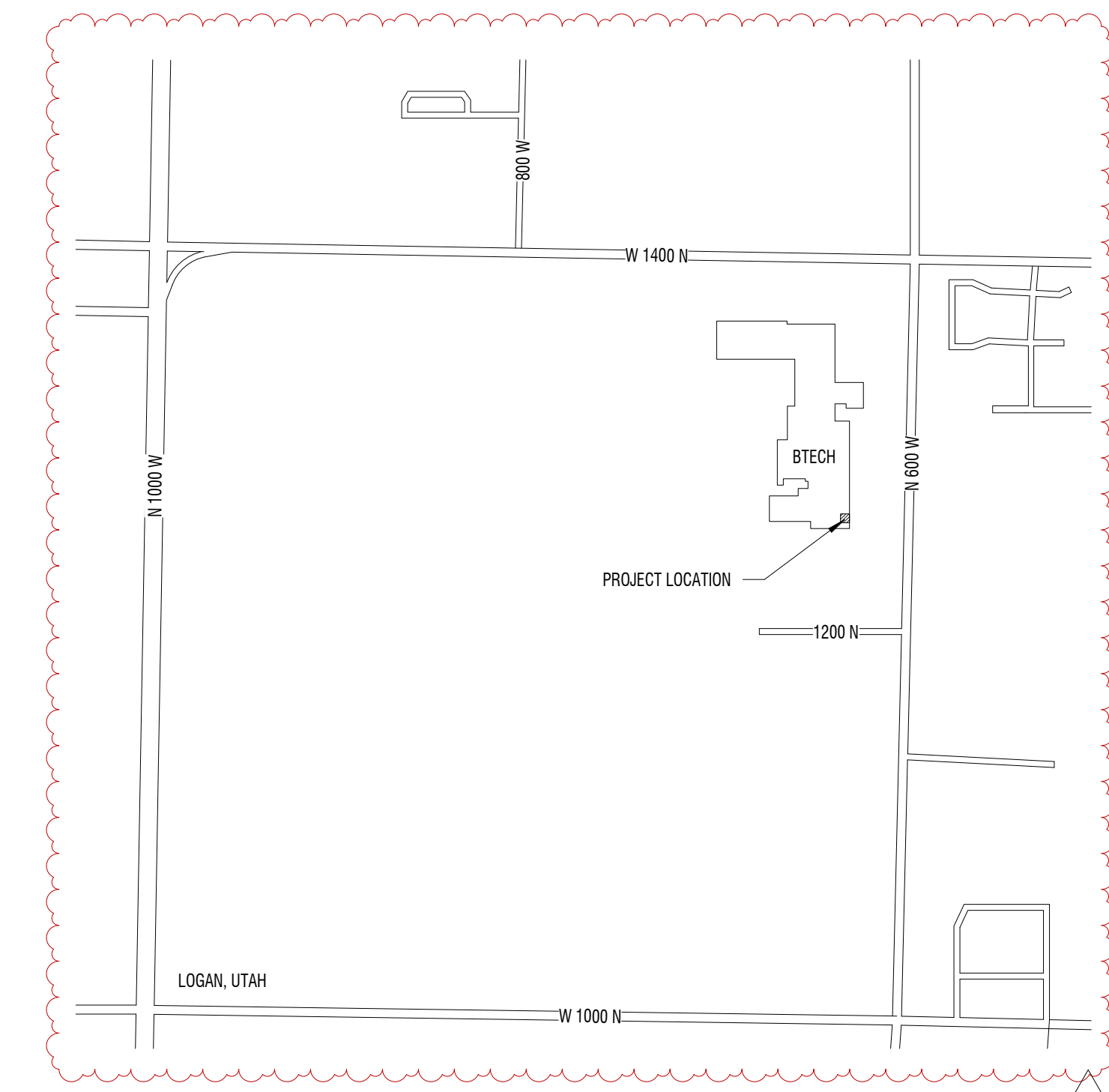

MARK	DESCRIPTION	DATE
AD1		6/14/2023

PROJECT #: 323202
DRAWN BY: HASLAM
CHECKED BY: WILLIAMS
ISSUED: 06.09.2023

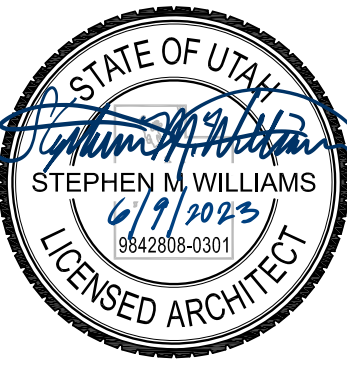

6/14/2023 11:34:40 PM C:\Users\stephenw\Documents\323202 - BTECH Meat Services - Freezer Floor Replacement - uprform\main01.rvt

MARK	DESCRIPTION
02.01	EXISTING FLOAT APPLIED FLOORING SYSTEM TO BE REMOVED.
02.02	EXISTING QUARRY TILE AND GROUT TO BE REMOVED.
02.03	EXISTING CONCRETE SUBSTRATE TO BE REMOVED.
02.04	EXISTING INSULATION BELOW CONCRETE SUBSTRATE TO BE REMOVED.
02.05	REMOVE EXISTING THRESHOLD. MAINTAIN TO BE REINSTALLED.
02.06	SAW CUT SUB-SLAB AS FLUSH AS POSSIBLE TO PREFABRICATED COOLER PANEL.
02.07	OVEREXCAVATE SUBGRADE SUCH THAT 4" OF GRAVEL FILL CAN BE INSTALLED.
02.08	1" GALVANIZED CONDUIT FOR HEAT TRACE LINES IN 1" SAND BED LAYER.

DFCM APPROVAL

BTECH MEAT SERVICES
FREEZER FLOOR REPLACEMENT
 1301 N 600 W, LOGAN, UT 84321
 BRIDGERLAND TECHNICAL COLLEGE
 DFCM PROJECT # - 2316210

DATE:	6/14/2023
DESCRIPTION:	AD1
MARK:	
PROJECT #:	323202
DRAWN BY:	HASLAM
CHECKED BY:	WILLIAMS
ISSUED:	06.09.2023

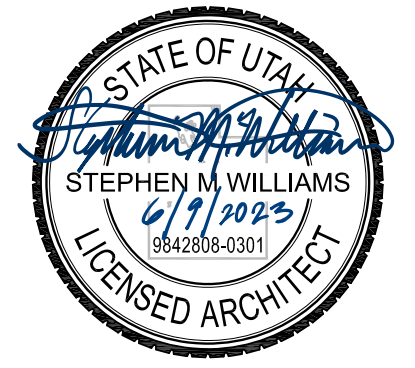

FLOOR PLAN,
 DEMOLITION PLAN &
 DETAILS

A-101

CONSTRUCTION DOCUMENTS

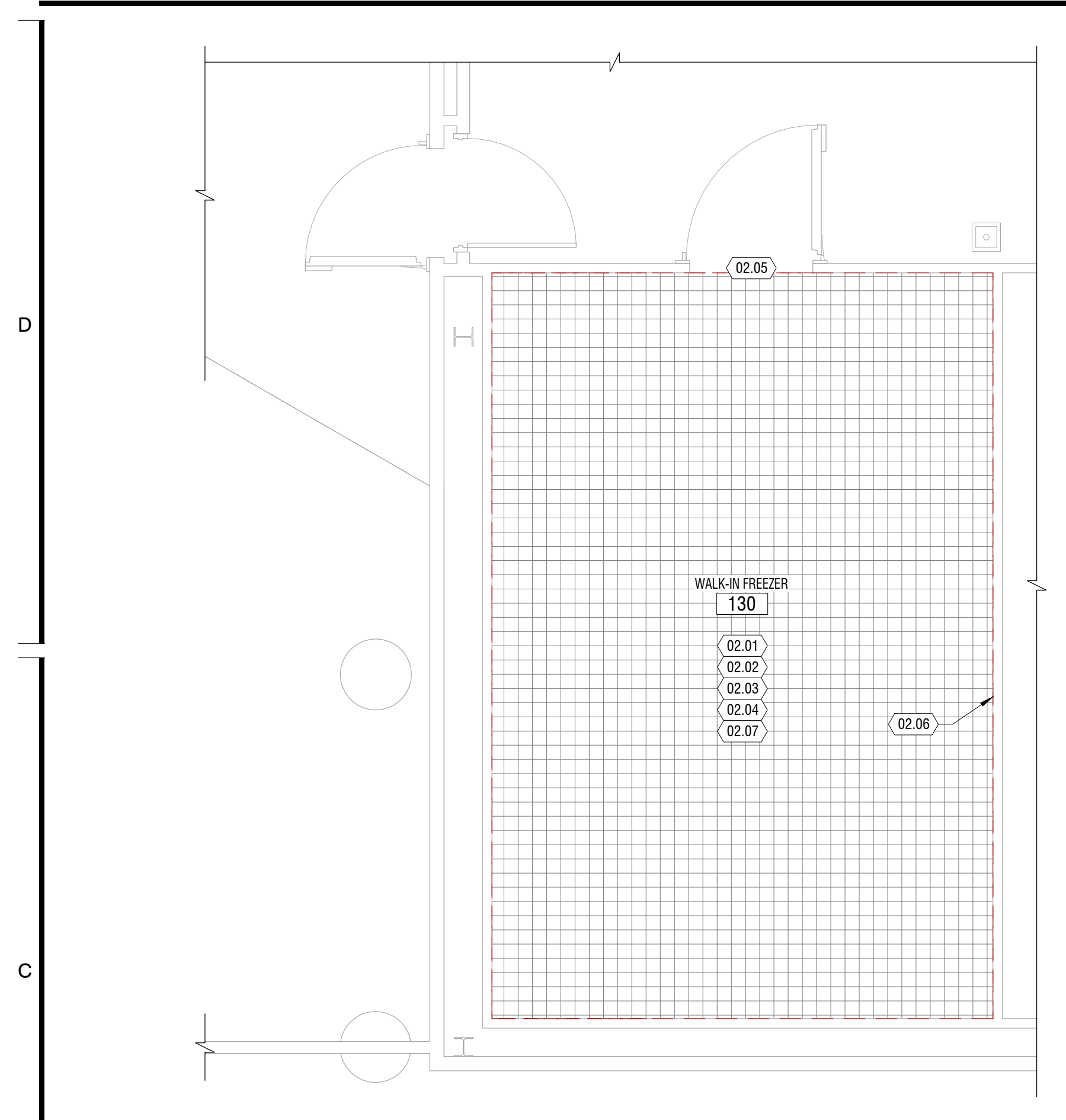

C1 PLAN - DEMOLITION

1/4" = 1'-0" WALK-IN FREEZER

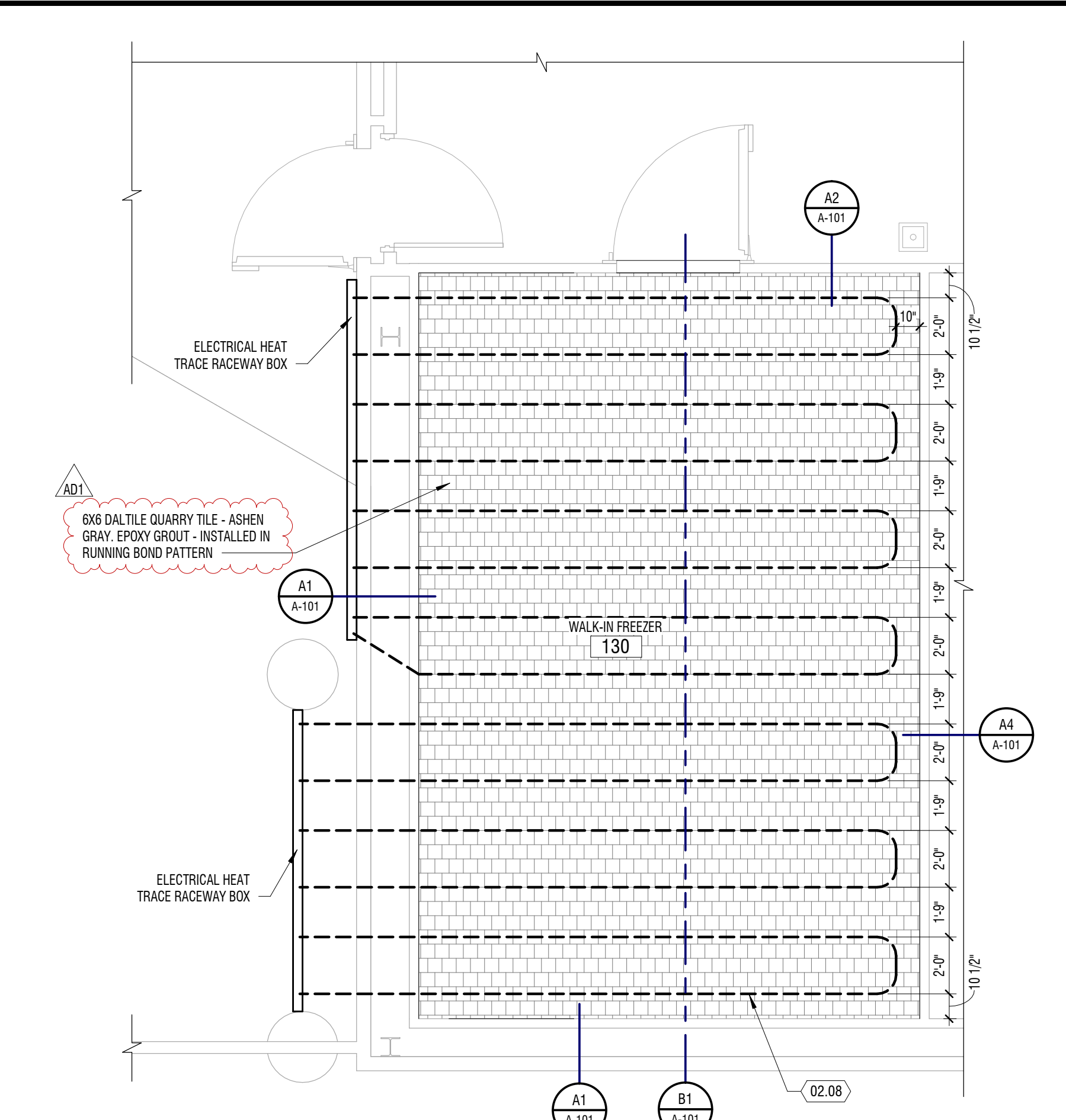

C3 FLOOR PLAN

1/4" = 1'-0" WALK-IN FREEZER

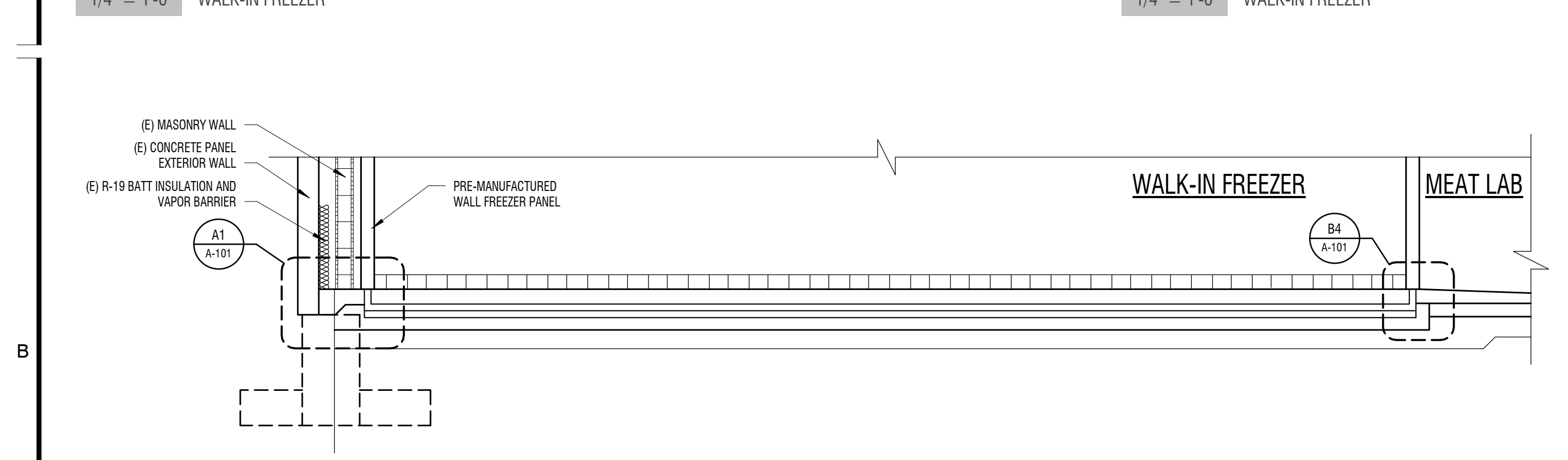

B1 SECTION

1/2" = 1'-0" WALK-IN FREEZER

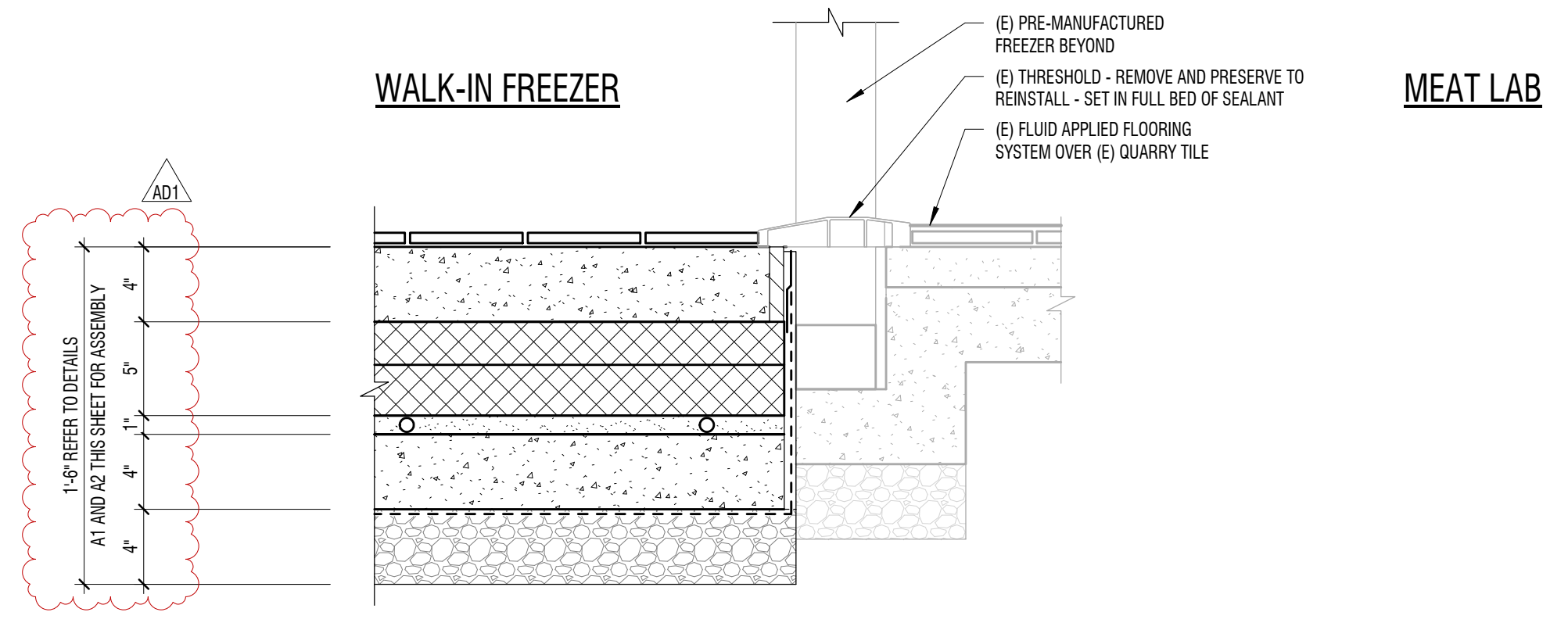

B4 DETAIL

1 1/2" = 1'-0" FLOOR JOINT

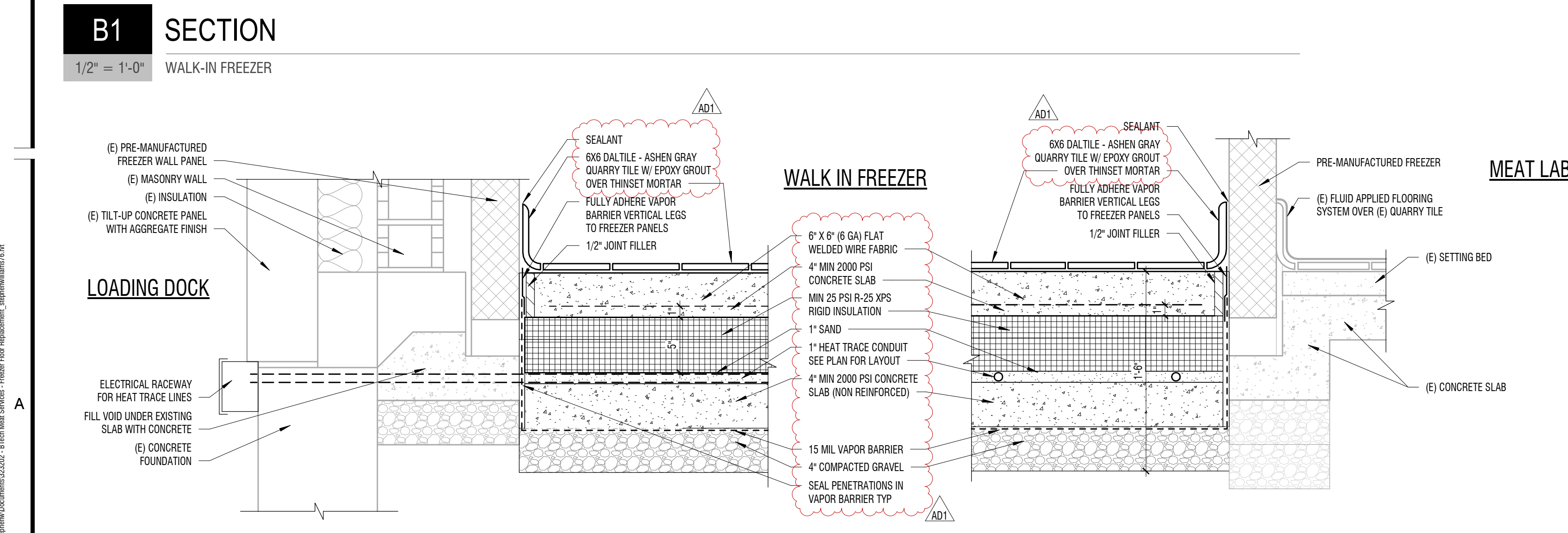

A1 DETAIL

1 1/2" = 1'-0" FLOOR JOINT

A2 DETAIL

1 1/2" = 1'-0" FLOOR JOINT

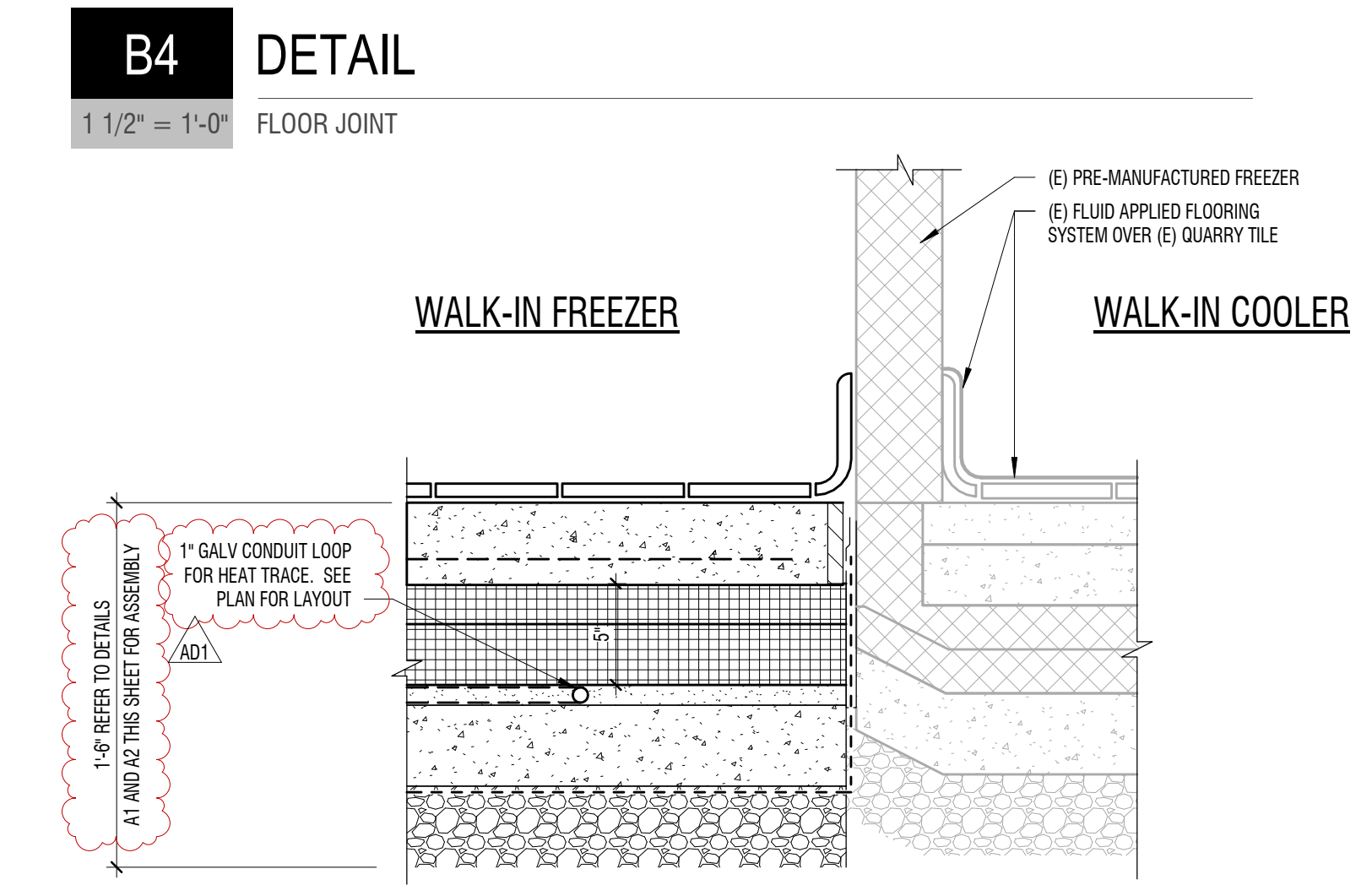

A4 DETAIL

1 1/2" = 1'-0" FLOOR JOINT

6/14/2023 11:34:43 PM C:\Users\stephwilliams\Documents\323202 - BTECH Meat Services - Freezer Floor Replacement - stephwilliams\B1.rvt